

Plasma 3

MY 2011

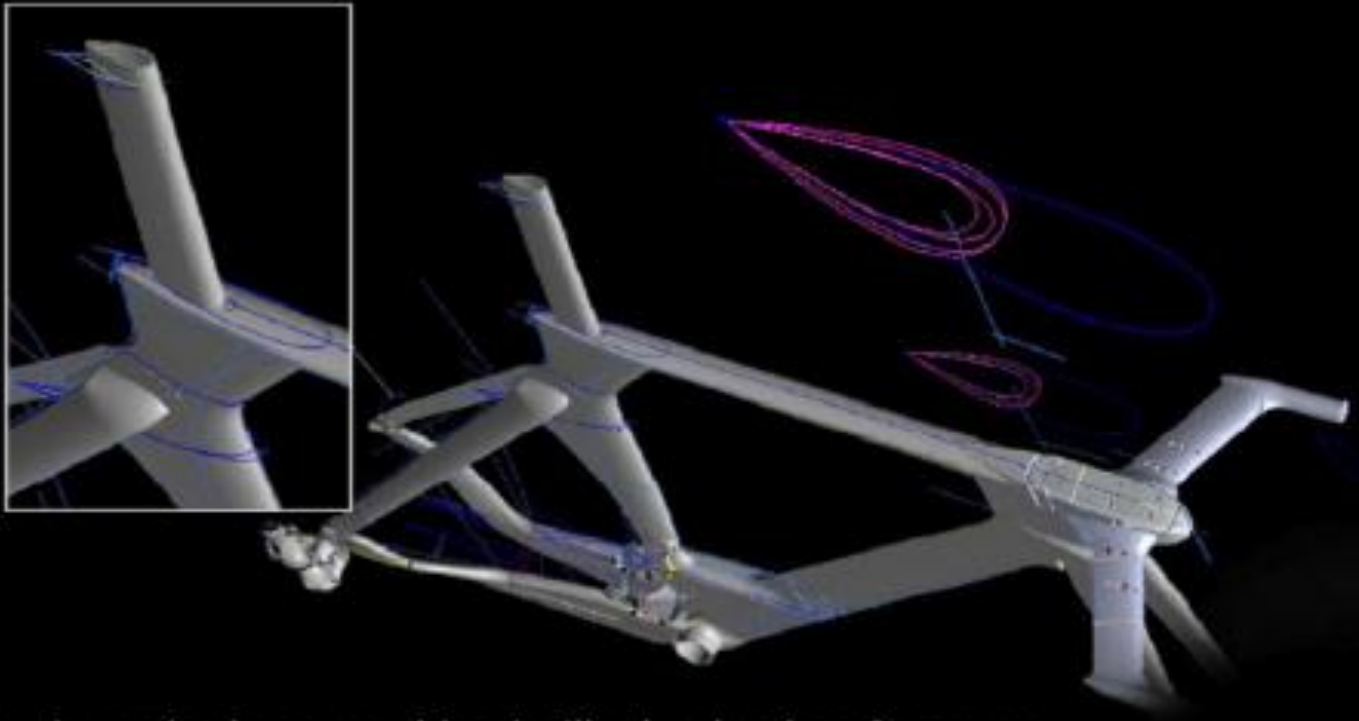



- Aerodynamic shape combined with structural performance
- Drag optimized profile on all tube sections
- All tubes meet UCI-legal 3:1 ratios

Plasma 3



- Fully integrated cable routing compatible with Shimano Di2
- Cables routed through stem
- Integrated battery

LIMITED AIR DRAG FROM ALL COMPONENTS

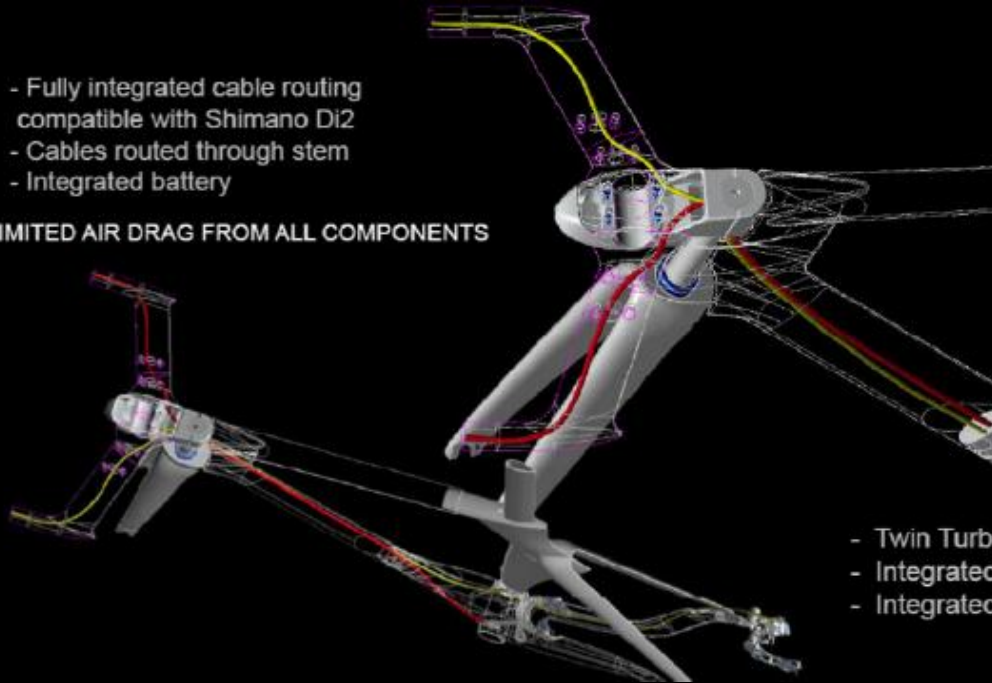

- Twin Turbo oversized chainstays
- Integrated rear brake
- Integrated bottom bracket

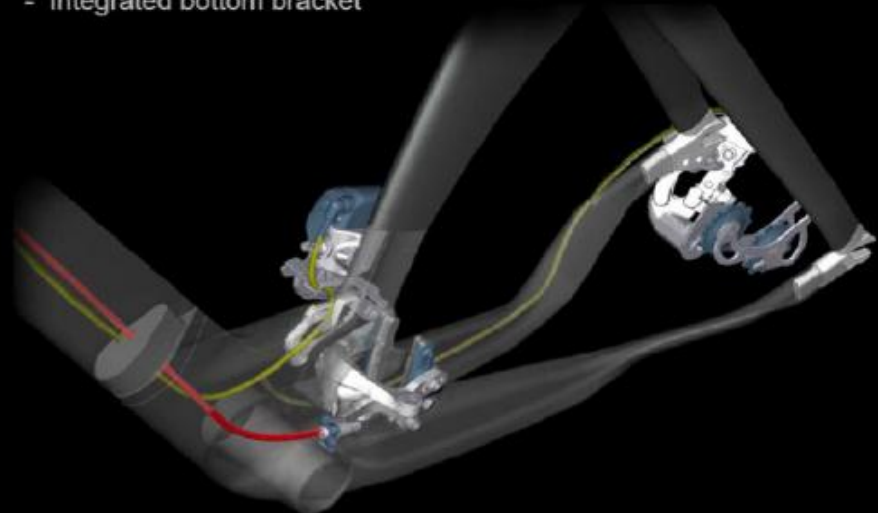

IMP TECHNOLOGY
ALLOWS COMPLEX CARBON SHAPES

Important:

The Plasma TT frame set can only be assembled with the stem/handlebar combination delivered with the frame set.

Other stems/handlebars will not fit properly and can even be dangerous in case combined with this frame set/fork system!



PLASMA TT FRAMESET

Black/Yellow color, zero rise stem, compatible only with Shimano Di2 electronic system.

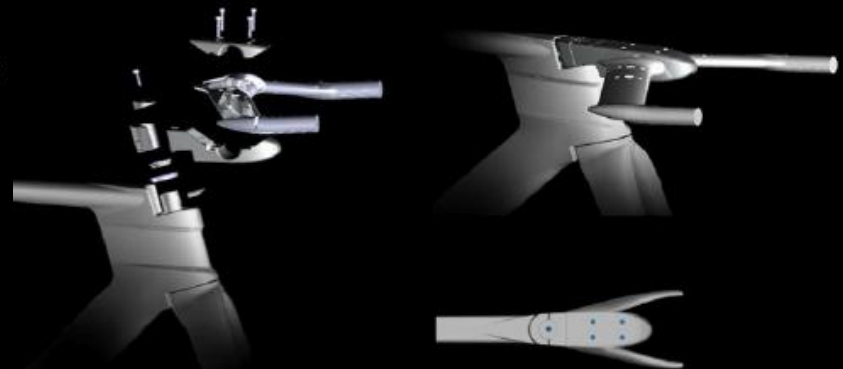

- Fully integrated frame and stem system
- Toptube and stem continuity



PLASMA PREMIUM FRAMESET

Black/Grey matte color, 40mm rise stem, compatible with cable-actuated drivetrains.

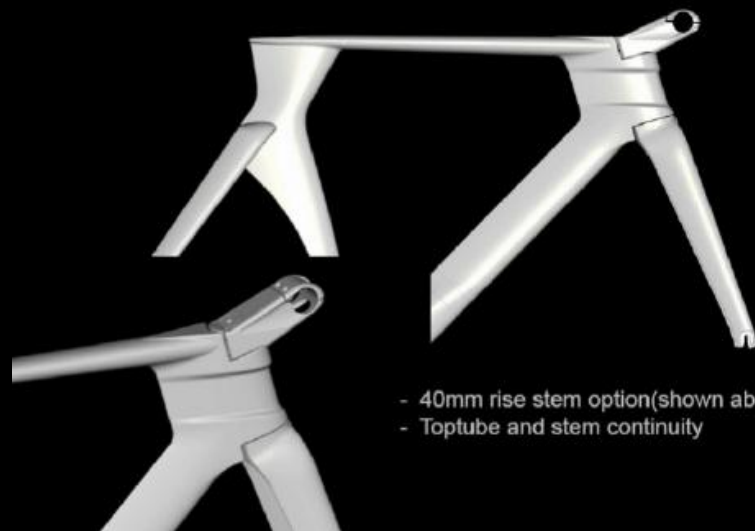

- 40mm rise stem option (shown above)
- Top tube and stem continuity

PLASMA 3

The seatpost of Plasma 3 needs to be cut on its downside. Please make sure that the seatpost touches the base of the seatpost pocket inside the frame to avoid a slipping seatpost.

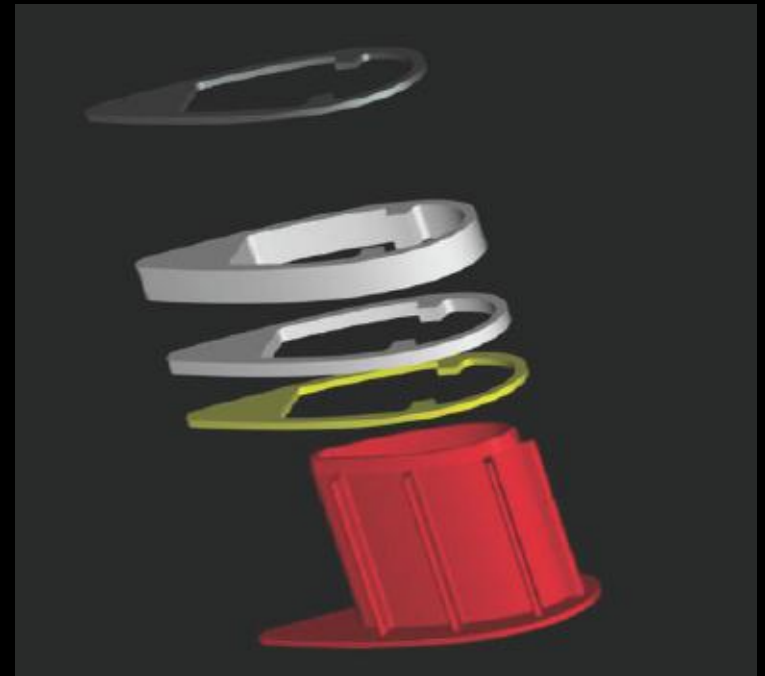
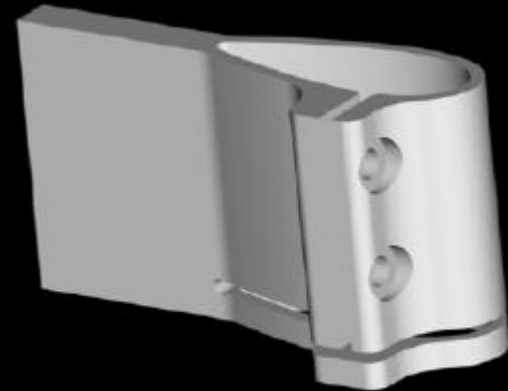
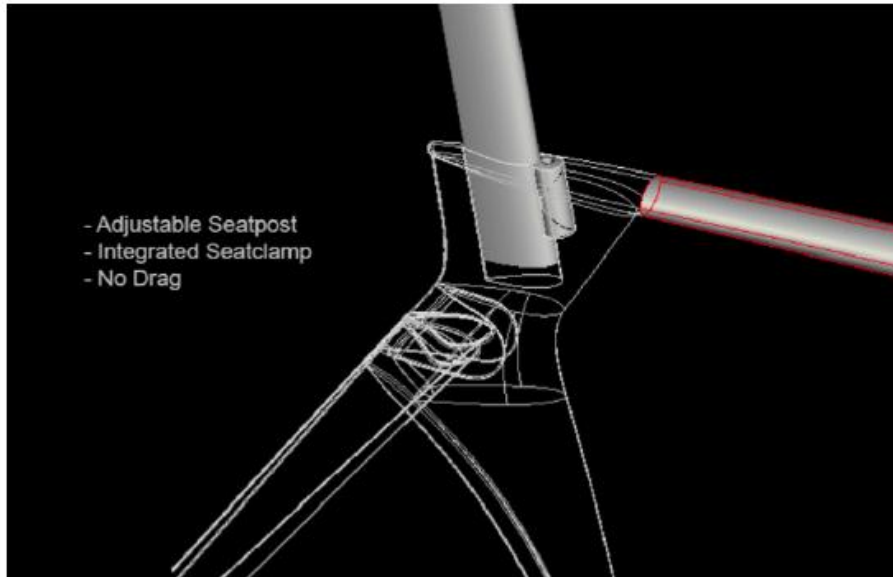

1. Take the exact measure of the distance (d0) from the mid of axle of your pedal to the upper side of the saddle you use already on your "old" bike which is exactly adjusted to your seat position.

Important: pls note that the change to another saddle or pedal model might influence a lot the length of the seatpost!

2. Mount your pedals and saddle on the Plasma 3/TT bike. For the cutting, position your seatpost as low as possible in the frame and measure the distance (d1) from the mid of the pedal axle to the upper side of the saddle. Remove the seat clamp and measure the distance (d2) from the downside of the seatpost: $d2 = d1 - d0$
3. Indicate the length (d2) you want to cut on the seatpost with a marker pen.

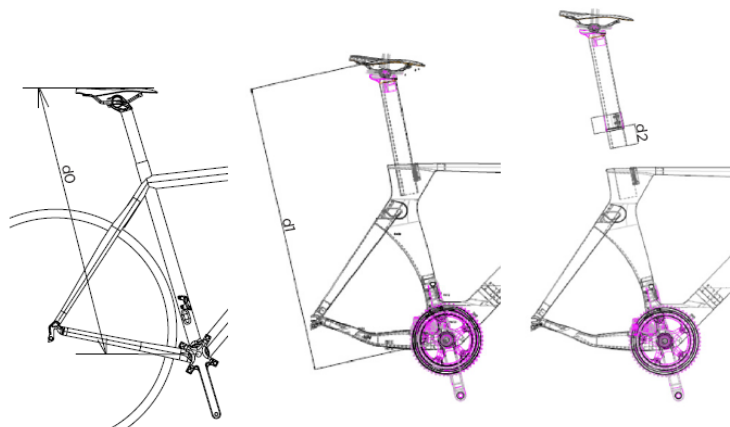

4. Slide the Plasma Cutting Tool on the seatpost of Plasma 3/TT until the line of the marker is visible in the slot on the tool that will guide your saw blade. drawing
5. Fix the two 5mm bolts with a 4mm Allen key with a tightening torque of 6 Nm.
6. Take a saw with a blade for cutting metal. Please only use a 10D/24T teeth blade to make sure not to damage the carbon tube warning logo
7. Cut the tube, remove the tool and take sandpaper to smoothen the edges of the cutting area.
8. Remount the seatpost and tighten the wedge on the frame with a torque of 5 Nm.

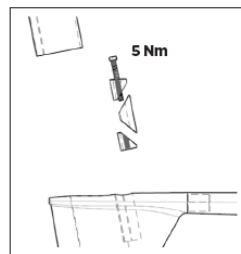

Please only use Shimano BR-7800 as this brake will offer enough clearance between the brake arms and the cranks.

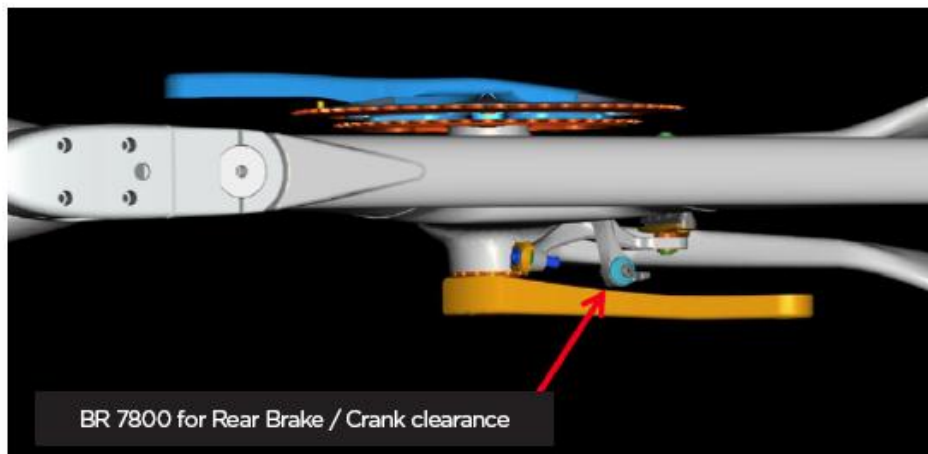
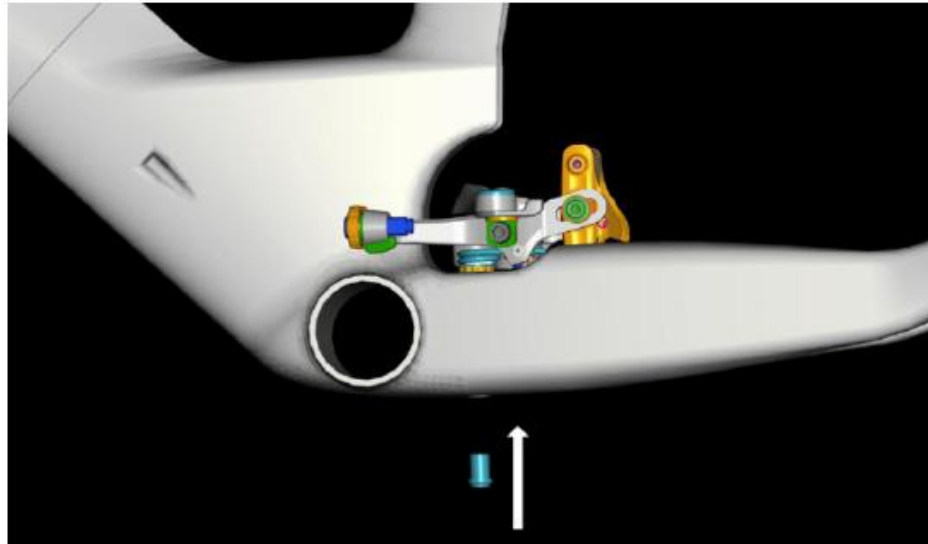

Plasma 3



CABLE ROUTING ON PLASMA 3

PLASMA 3 TT VERSION

As already before-mentioned the frame set of Plasma 3 TT is only made for the use with Shimano Di2 shifting parts.

To do so you will need the following parts of Shimano Di2:

2 x EW-7975 (use 2 sets if the battery is mounted behind the saddle) an extension for the battery cable is needed; we used a second RD cable for this

1 x SM-EW 79A-I or SM-EW 79A-I2

1 x ST-7971

1 x SW-7971

1 x RD-7970

1 x FD-7970

1 x SM-BTR1

To assemble the cables please follow the steps as shown:



1. Assembly lower bearing on fork carbon crown

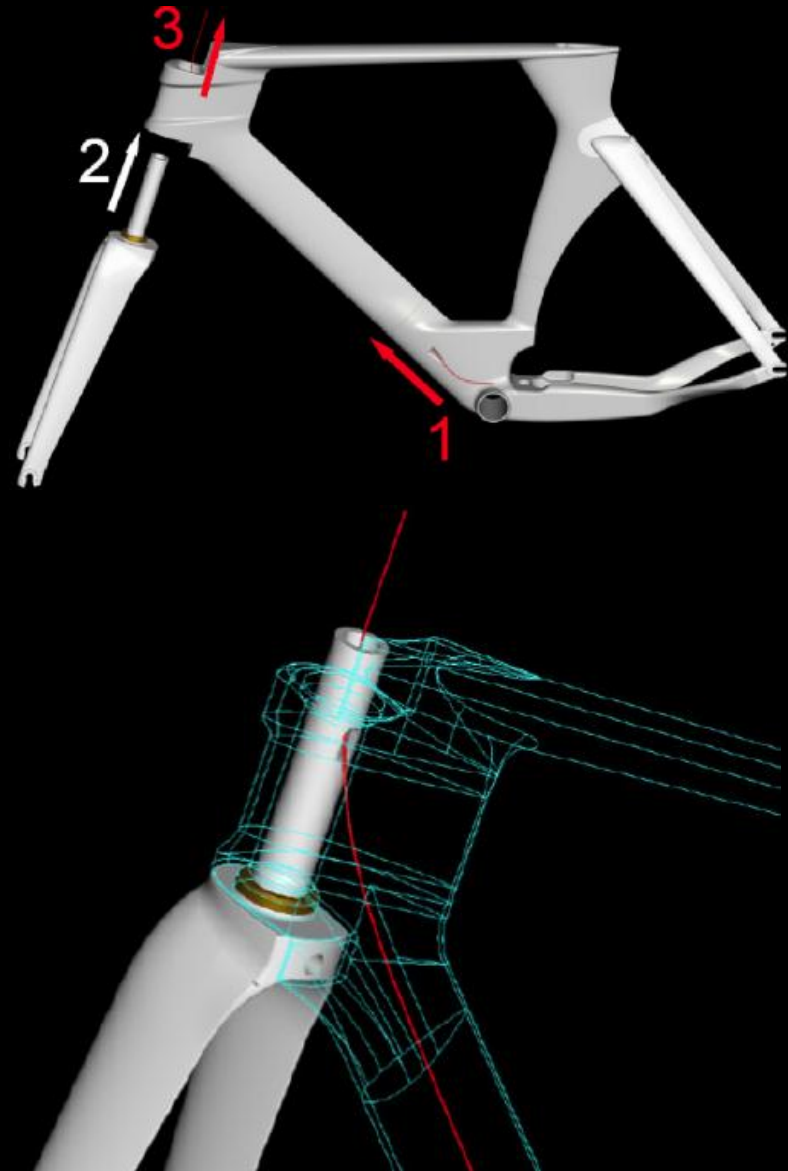

Plasma 3

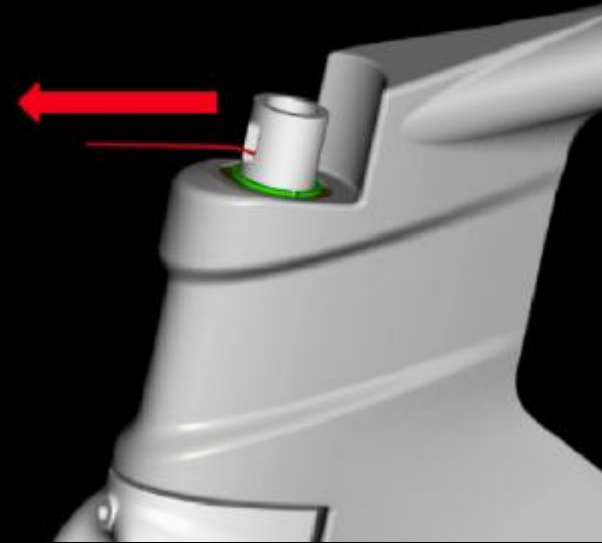
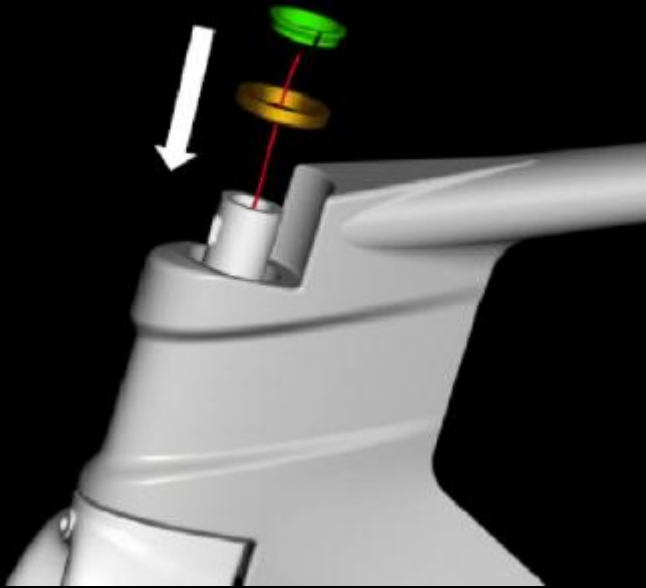

CABLE ROUTING ON PLASMA 3 TRIATHLON VERSION

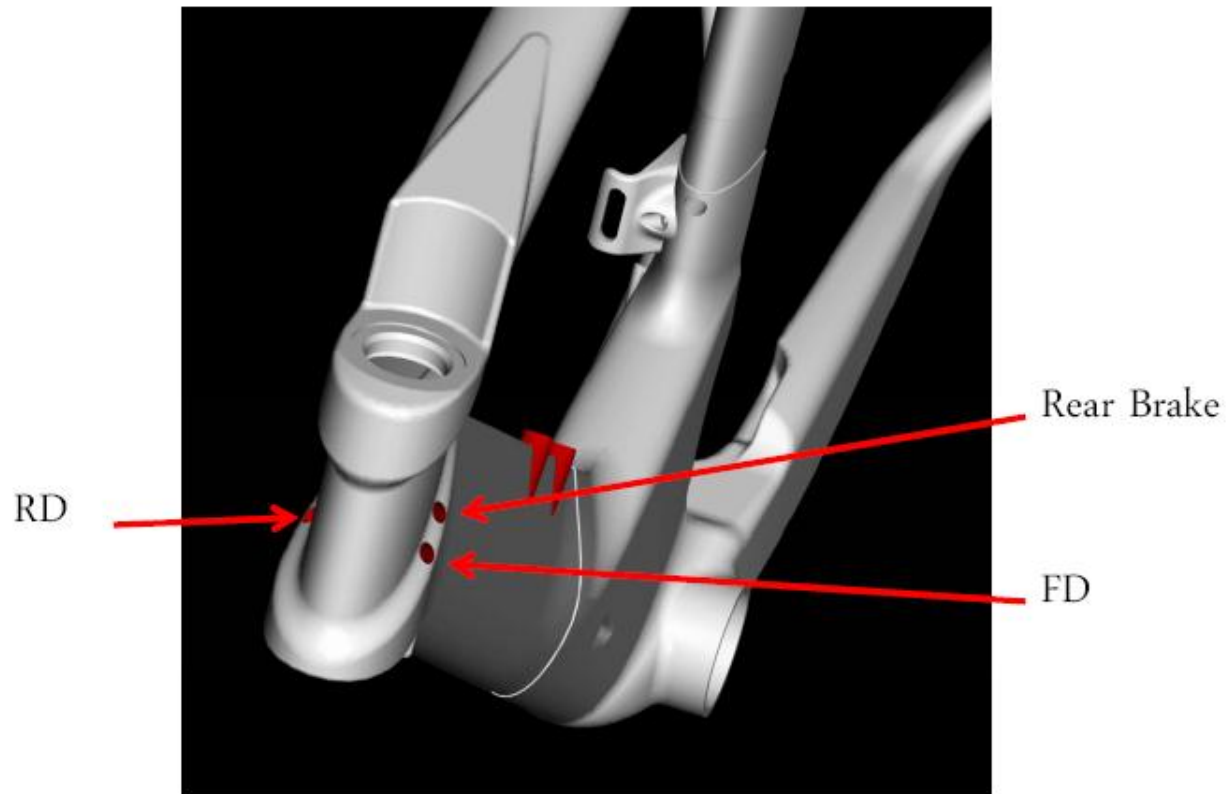

**Thanks for your time
and attention!**