



# L6 LACE ATTACHMENT & REEL ASSEMBLY

## EYESTAY - TX4

(1 of 4)

**LowPower**  
Lace Attachment

**LEFT**

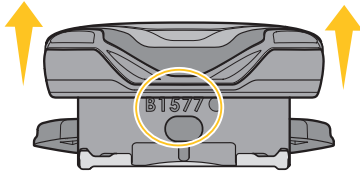

L6 Left Eyestay  
20mm - B1577  
25mm - B1579

Blue for  
"Left"

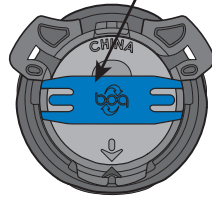

**RIGHT**

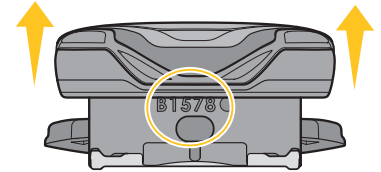

L6 Right Eyestay  
20mm - B1576  
25mm - B1578

Red for  
"Right"

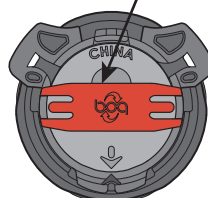

For lacing FormTX Guides ONLY:

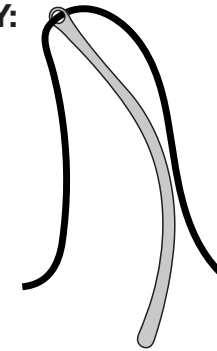

FormTX Lace  
Feeder Tool  
B1721

For lacing L6 Reels  
with TX4 lace ONLY:

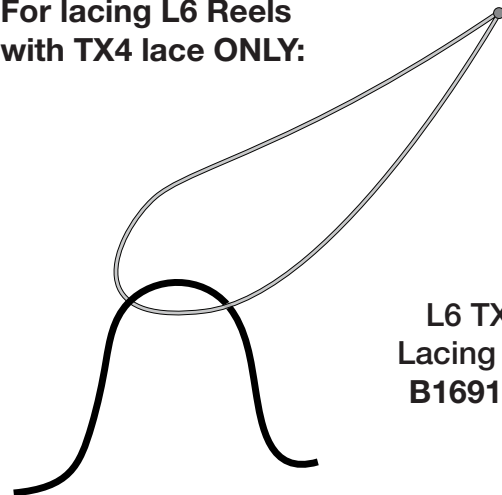

L6 TX4  
Lacing Tool  
B1691\_30

## — LACE ATTACHMENT ▼



**BEFORE YOU BEGIN LACE ATTACHMENT, VERIFY YOU HAVE THE CORRECT DIAL FOR LEFT OR RIGHT SHOES**

**LEFT SHOE**

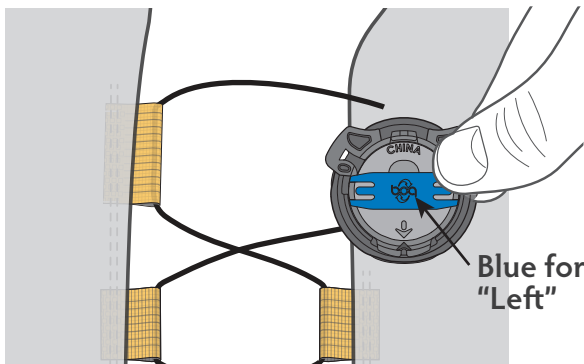

Blue for  
"Left"

**RIGHT SHOE**

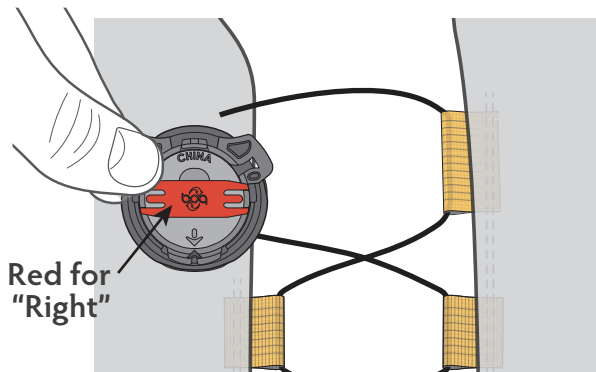

Red for  
"Right"



# L6 LACE ATTACHMENT & REEL ASSEMBLY

## EYESTAY-TX4

(2 of 4)

**LowPower**  
Lace Attachment

### 1 ENSURE DIAL IS CLOSED

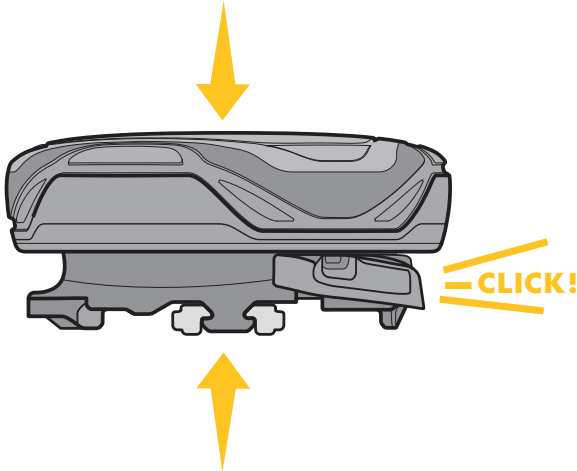

### 2 ALIGN ARROWS ON BACK OF REEL

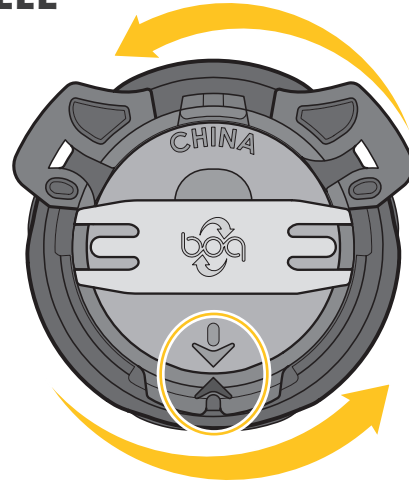

### 3 USE LACING TOOL TO PULL LACE THROUGH REEL EXITS

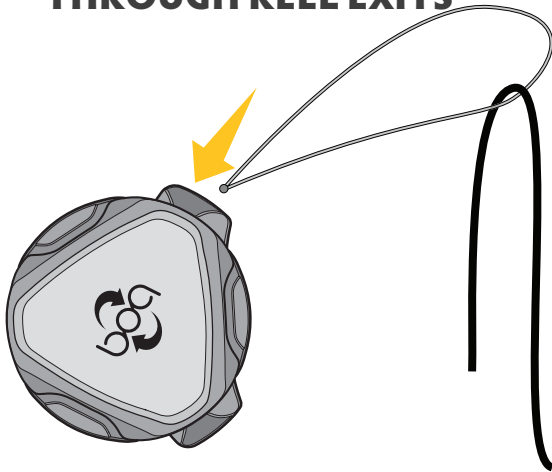

### 4 VERIFY LACE IS THROUGH CORRECT REEL EXITS

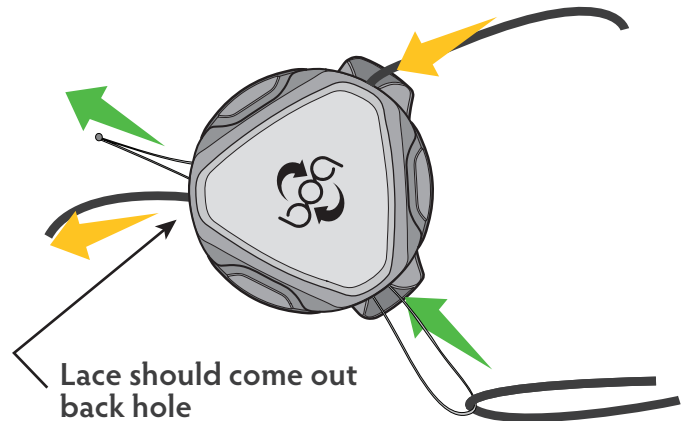

### 5 INSERT LACE INTO CORRECT REEL EXITS

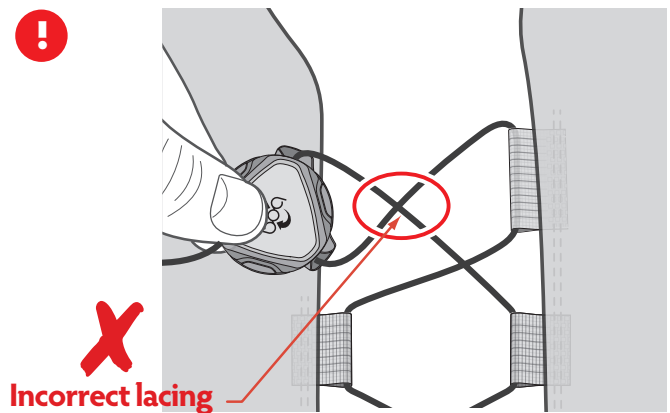
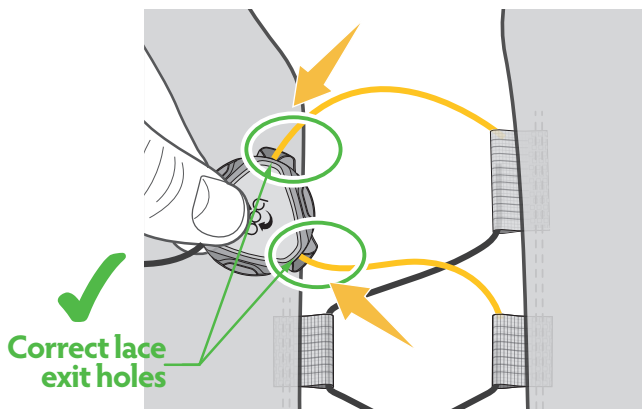



# L6 LACE ATTACHMENT & REEL ASSEMBLY

## EYESTAY-TX4

(3 of 4)

**LowPower**  
Lace Attachment

### 6a TIE SINGLE OVERHAND KNOT



### 6b ENSURE KNOT IS SET

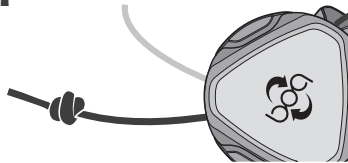

### 7a MELT TAIL DOWN TO KNOT

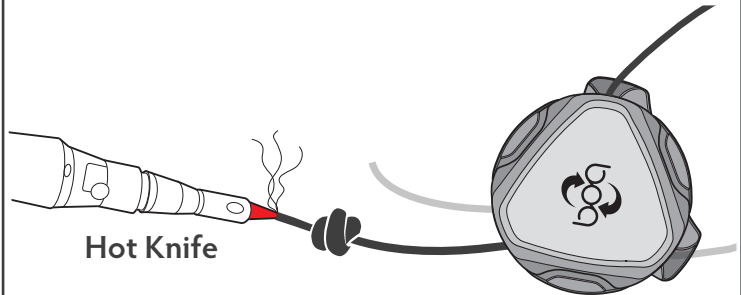

Hot Knife

**! DO NOT melt knot**

### 7b QC: VERIFY CORRECT TAIL MELT

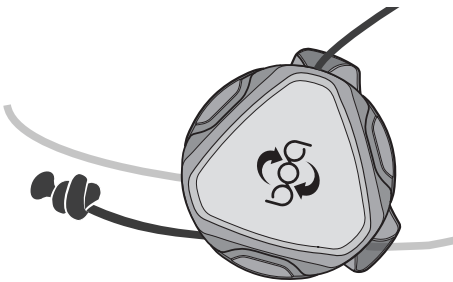

**✓ CORRECT**

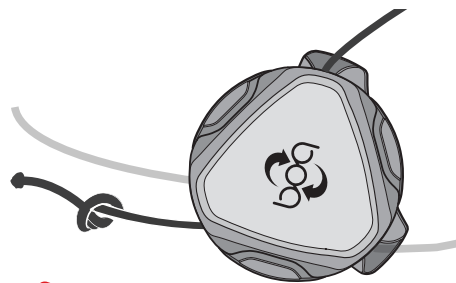

**✗ WRONG TAIL TOO LONG**

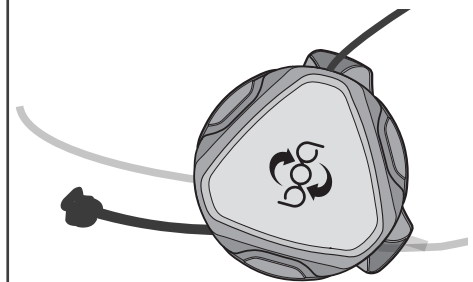

**✗ WRONG MELTED KNOT**

### 8 PULL KNOT COMPLETELY INTO REEL

Knot and tail should not be visible

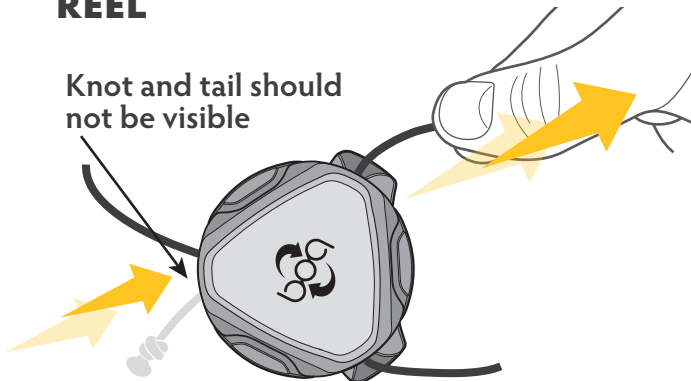

### 9 REPEAT FOR OTHER SIDE STARTING AT STEP 6

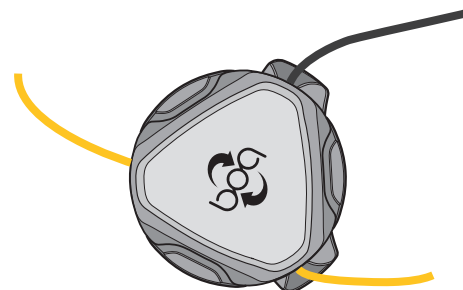



# L6 LACE ATTACHMENT & REEL ASSEMBLY EYESTAY-TX4 (4 of 4)

**LowPower**  
Lace Attachment

## 10 QC: NO LACE SHOULD BE STICKING OUT BACK BY PART NUMBER

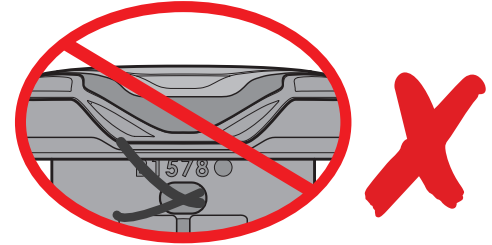
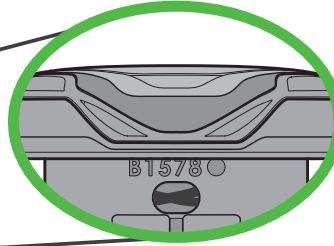
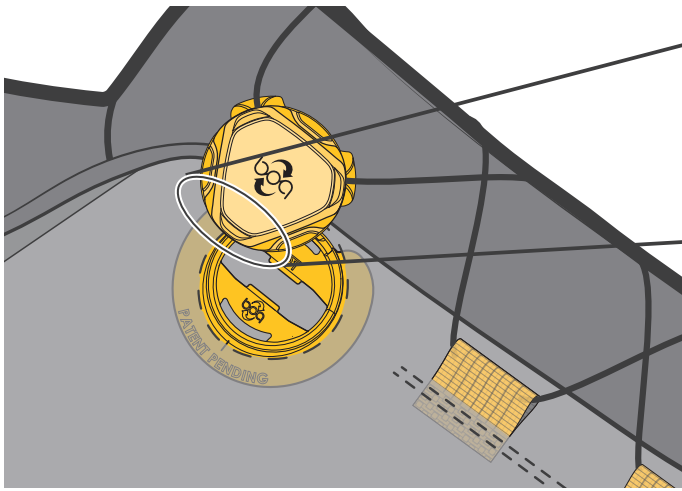

## 11 SNAP REEL INTO BAYONET

**a**

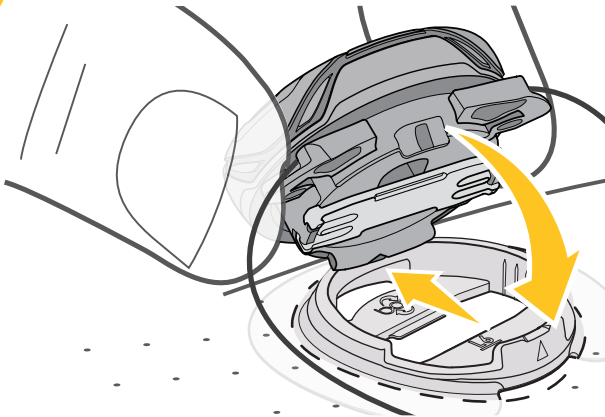

**b**

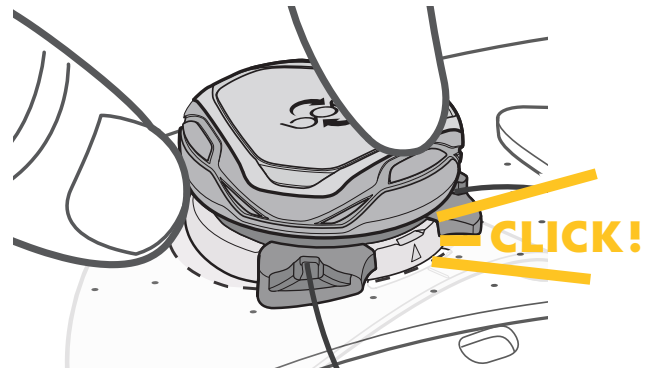

**ENSURE REEL IS FULLY  
SNAPPED INTO BAYONET**

## 12 QC: VERIFY DIAL TIGHTENS LACE WHEN TURNED IN PROPER DIRECTION

**LEFT SHOE**



Dials should turn  
towards toe of shoe

**RIGHT SHOE**

