

SHIMANO STEPS E8000

ASSEMBLY & SETTINGS

CONTENTS

Sub title

SHIMANO

Technical specifications

Assembly

Charging port

Battery indicator

DU cover

Assembly tool

Compatibility chart



OVERVIEW



DU-E8000

- ▶ Drive unit
- ▶ 70Nm (max), 250W
- ▶ for RD only



SM-CRE80-B

- ▶ Chain ring set
38T or 34T for
chainline 50 mm

SM-CRE80-B

- ▶ Chain ring set
38T or 34T for
chain line 53 mm



DU-E8000

- ▶ Drive unit
- ▶ 70Nm (max), 250W
- ▶ for RD only



SM-CRE80-B

- ▶ Chain ring set
38T or 34T for
chainline 50 mm

SM-CRE80-B

- ▶ Chain ring set
38T or 34T for
chain line 53 mm



[SM-CRE80-12 for M9100]

FC has dynamic chain engagement tooth design



SM-CDE80 - Chain device (optional)

- ▶ for chain line 53 mm assembly with back plate to the drive unit
- ▶ for chain line 50 mm and 53 mm: possibility for direct mount to the frame
- ▶ for chainline 50 mm: no backplate possible



SM-DUE10

- ▶ Speed sensor

CN-HG701-11

- ▶ 11-speed chain

CN-E6090-10

- ▶ 10-speed chain

CRANKS AND COVER

SHIMANO

FC-E8050

- ▶ Hollow crank arm set (two piece crank arm)



FC-E8000

- ▶ Crank arm set (two piece crank arm)



COVER A

SHIMANO

SM-DUE80-A

- ▶ Left DU cover



SM-DUE80-A

- ▶ Right cover



SM-DUE80-B

- ▶ Left DU cover



SM-DUE80-B

- ▶ Right cover



BT-E8010

- ▶ Down tube battery
- ▶ 504Wh / 36V
- ▶ Black

BM-E8010

- ▶ Battery mount

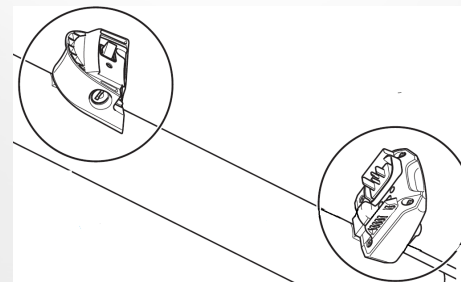

INTERNAL BATTERY

SHIMANO

BT-E8020

- ▶ Internal battery
- ▶ 504Wh / 36V

BM-E8020

- ▶ Battery mount

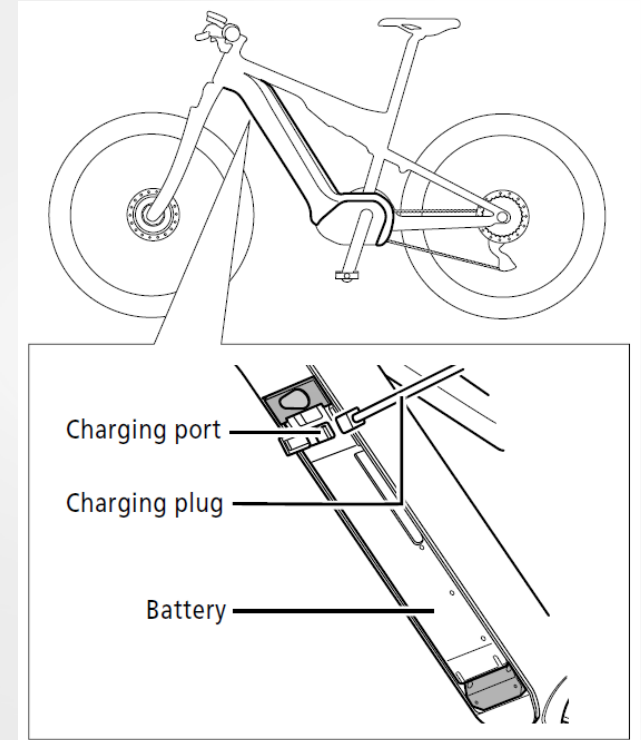

SW-E8000-L

- ▶ Switch



SC-E8000

- ▶ Display



Mechanical shifting or Electronic DI2 shifting

Intuitive operation

- ▶ Power mode change “like shifting”
- ▶ Ergonomic switch position for MTB riding

Power walk mode

- ▶ Motor assist available to push bike

Wireless programmability

- ▶ Customize through E-tube project application with smartphone and tablet
- ▶ Switch SW-E8000-L is different from XT DI2 switch in appearance and firmware.



Intuitive operation

- ▶ Bottom button to switch modes
- ▶ Modes support by use of colors

Dynamic feel

- ▶ Moving visuals when switching between modes
- ▶ Power input visualized by colored bar

Wireless programmability

- ▶ Customize through E-tube project application with smartphone and tablet

**Eco**

Riding support while enabling maximum range

Trail

Gradual support for encouraging sportive riding

Boost

Full support for maximum boost and uncompromised climbing

Short chain stays

- ▶ Shorter chain stay length ensuring better maneuverability

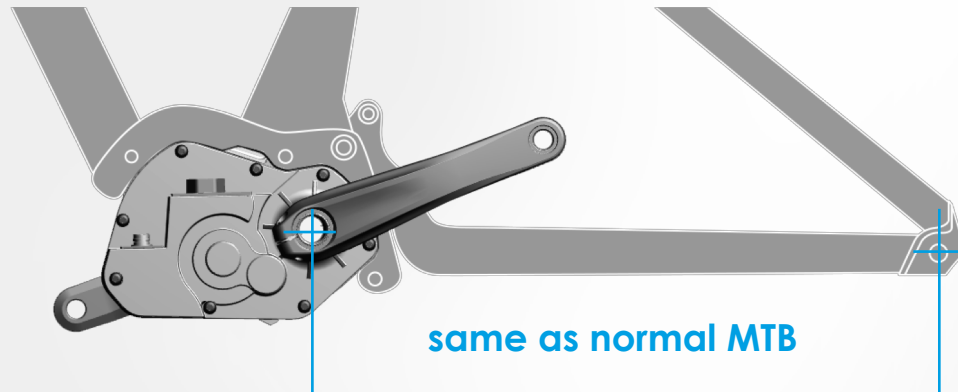

Narrow Q-factor

- ▶ Compact and light weight design for better handling with same Q-factor as current XT

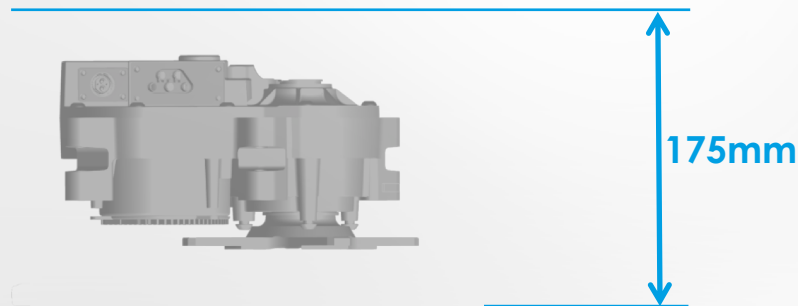

Optimally balanced mount positions with efficient power transfer

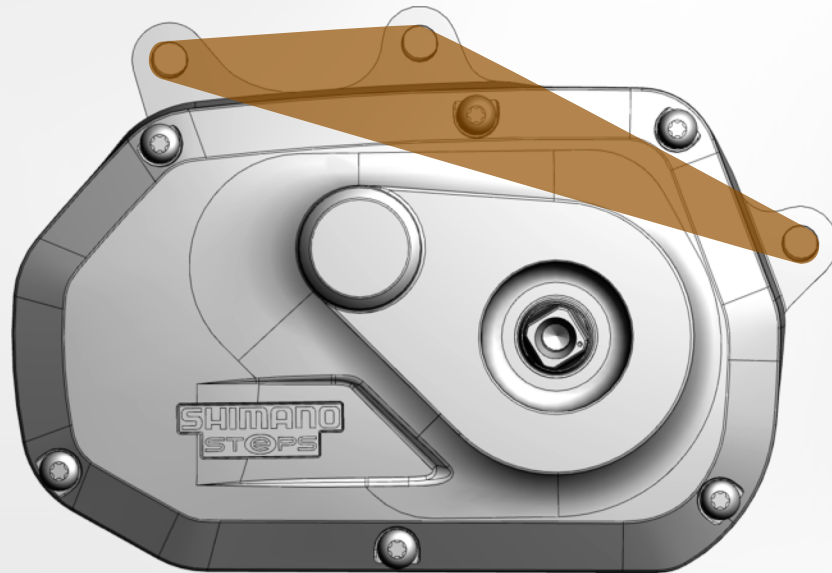
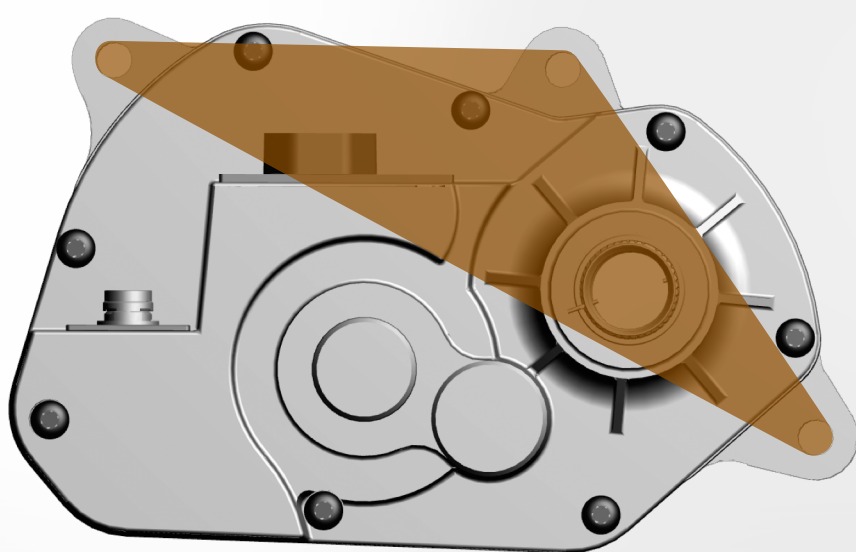

ASSEMBLY

DU is attached with 6 M8 standard bolts to the frame

- ▶ Bolts are not supplied by Shimano



ASSEMBLY - DRIVE UNIT

SHIMANO

- ▶ Bolts must be at least 8 windings in the mounting portion of DU
- ▶ Frame requirement: 50 ± 0.25 mm
- ▶ Max.size of DU: 49.5 mm
- ▶ Difference is balanced by flange bushing

Flange bushing

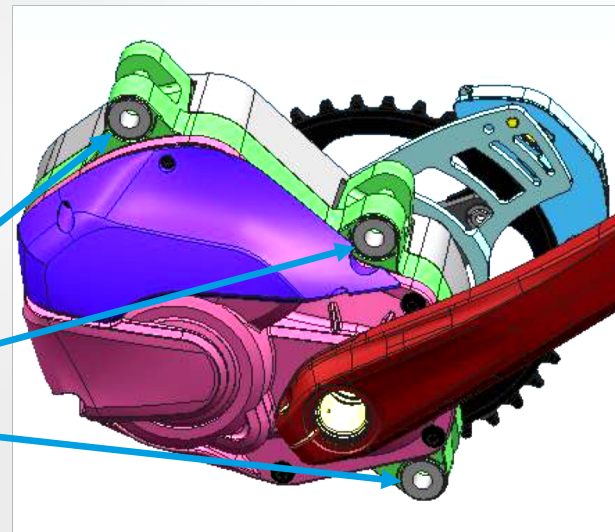

ASSEMBLY - DRIVE UNIT

SHIMANO

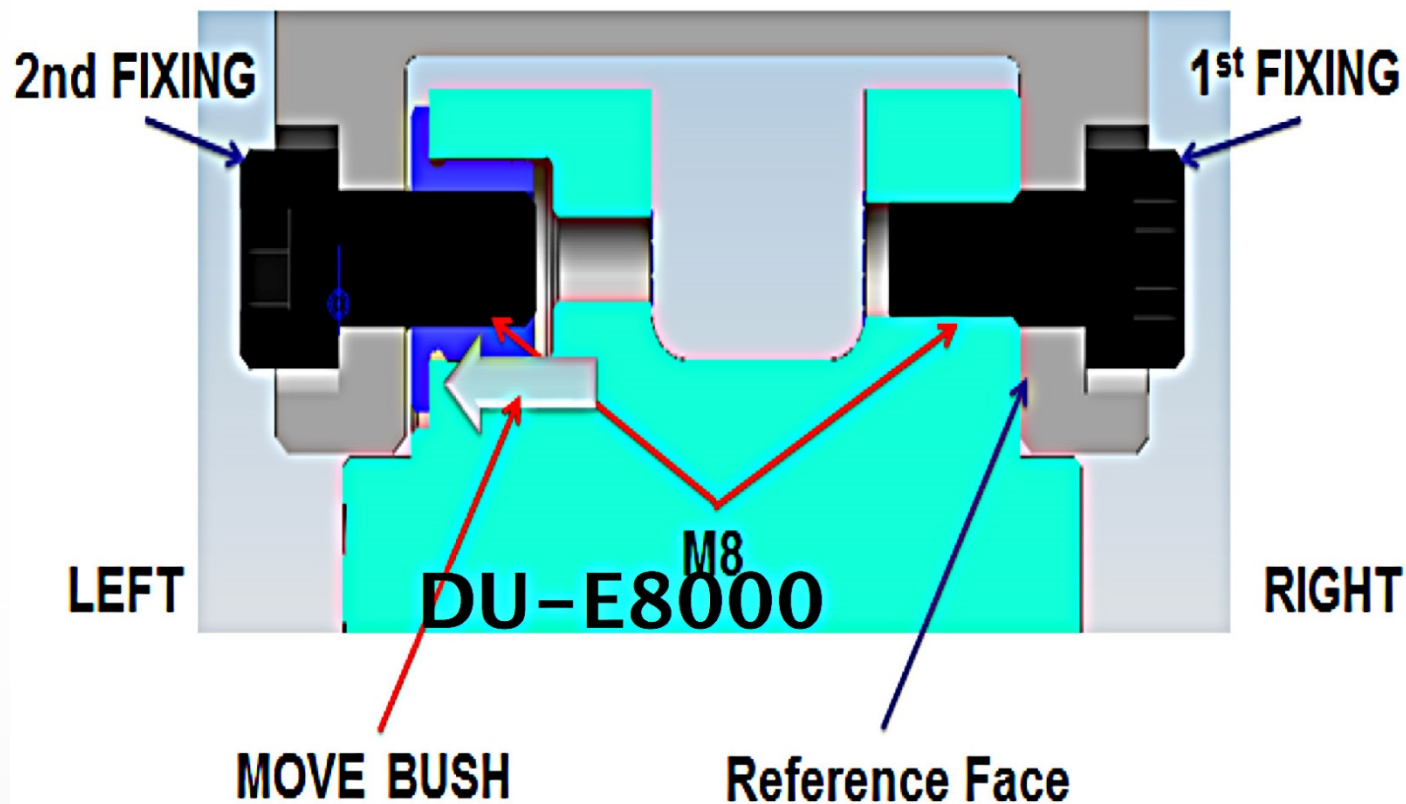

ASSEMBLY - DRIVE UNIT

SHIMANO

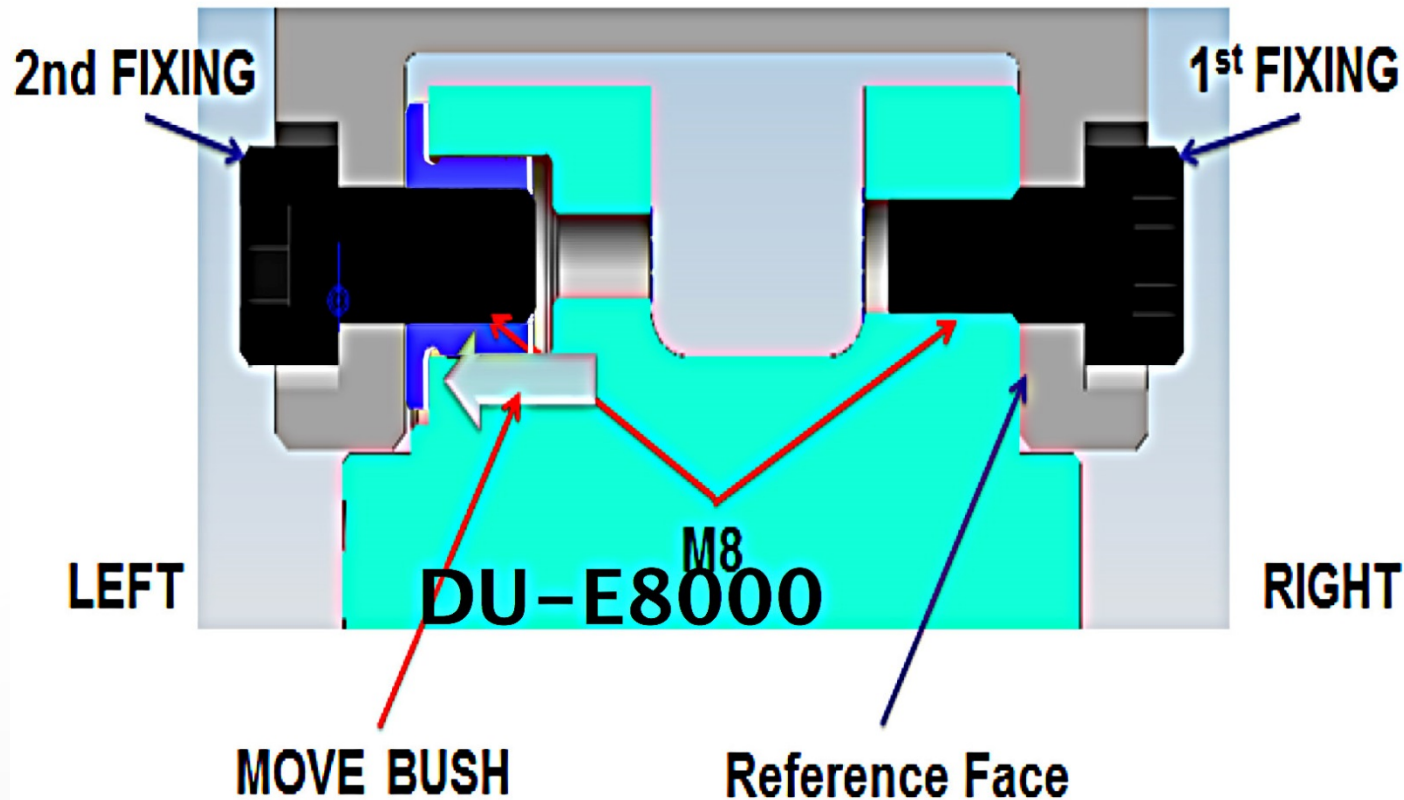

ASSEMBLY - DRIVE UNIT

SHIMANO

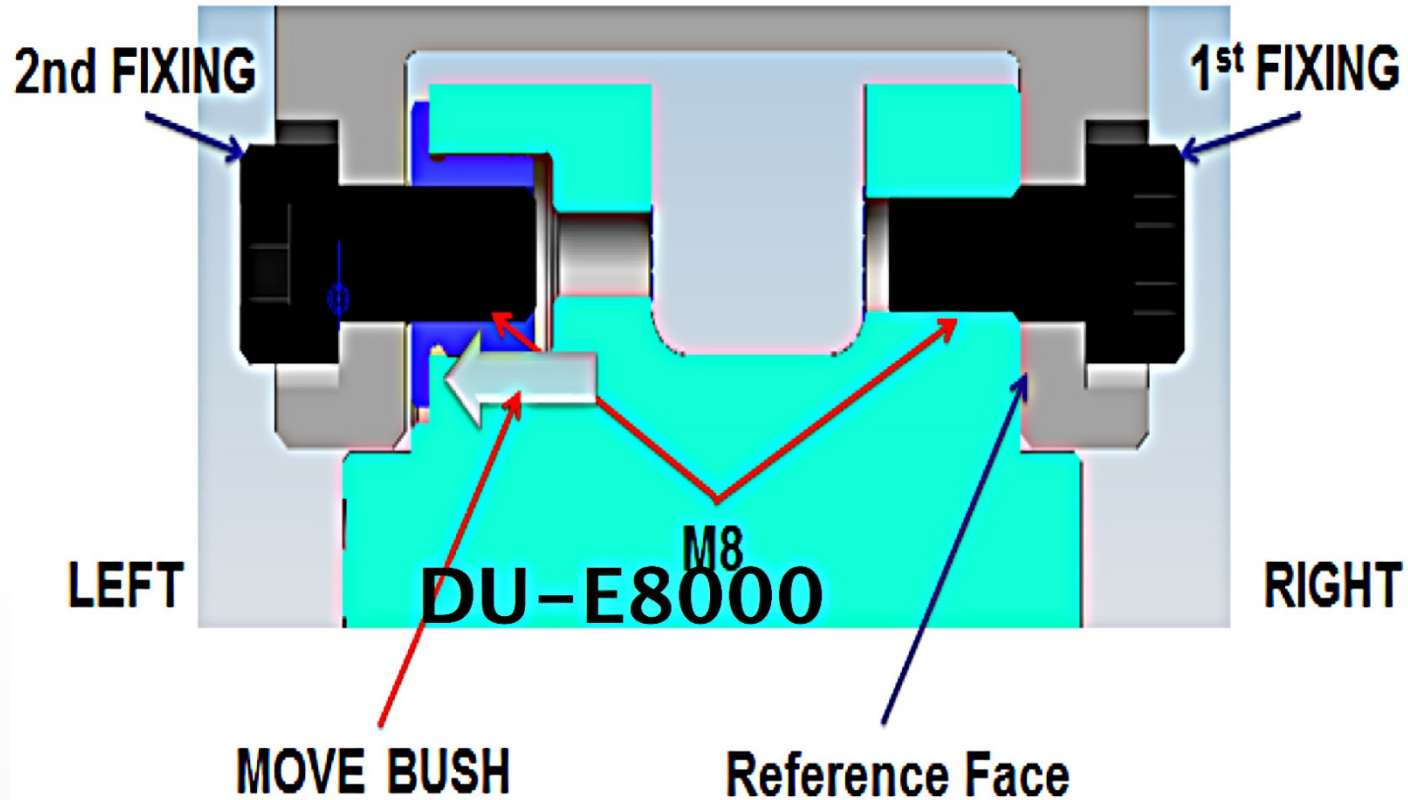

ASSEMBLY - DRIVE UNIT

SHIMANO

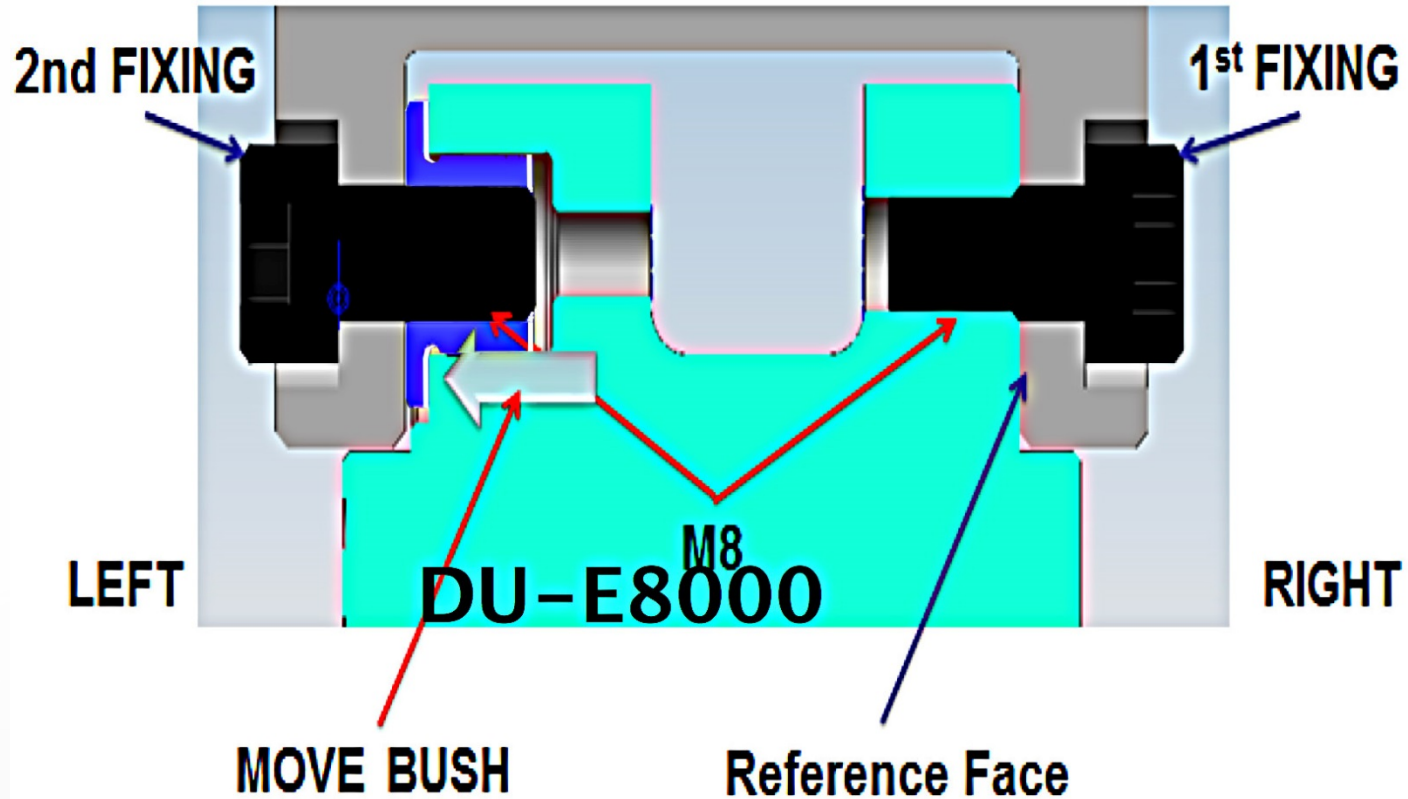

ASSEMBLY - DRIVE UNIT

SHIMANO

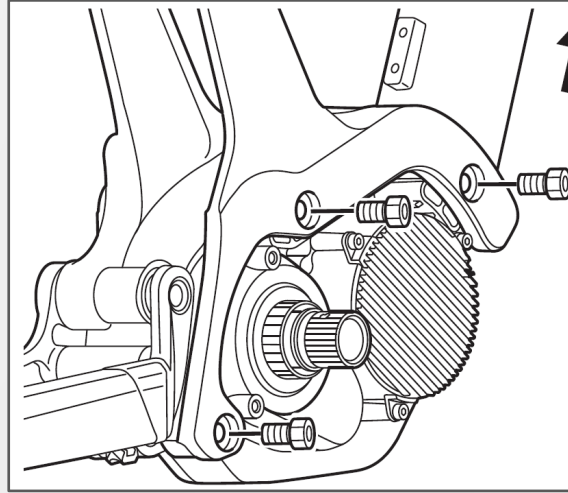
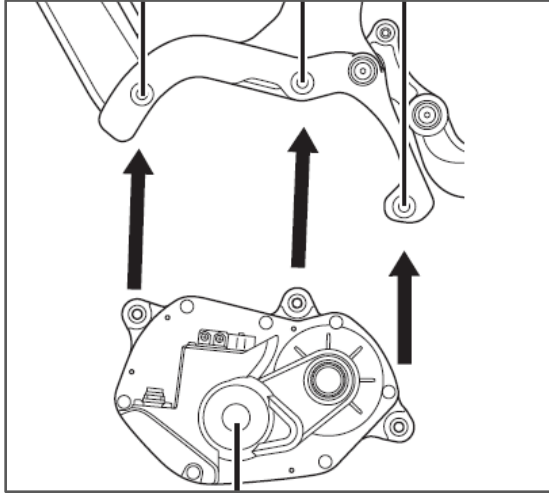

First insert the bolts on the right side

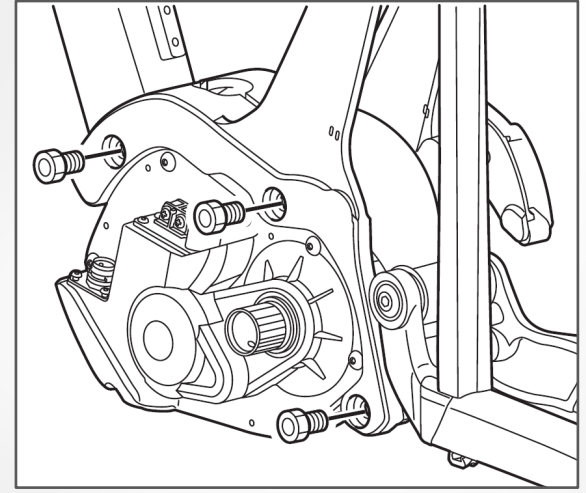

After this insert the bolts on the left side

ASSEMBLY - DRIVE UNIT

SHIMANO

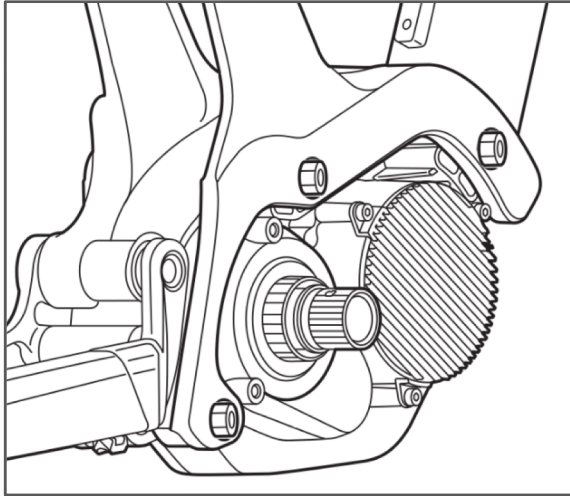

Then **tighten** the bolts
on the right side

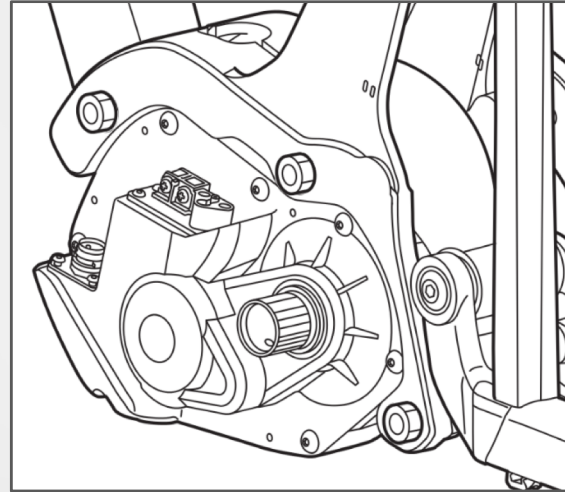

After this **tighten** the
bolts on the left side

ASSEMBLY - CONNECTING CABLES

SHIMANO

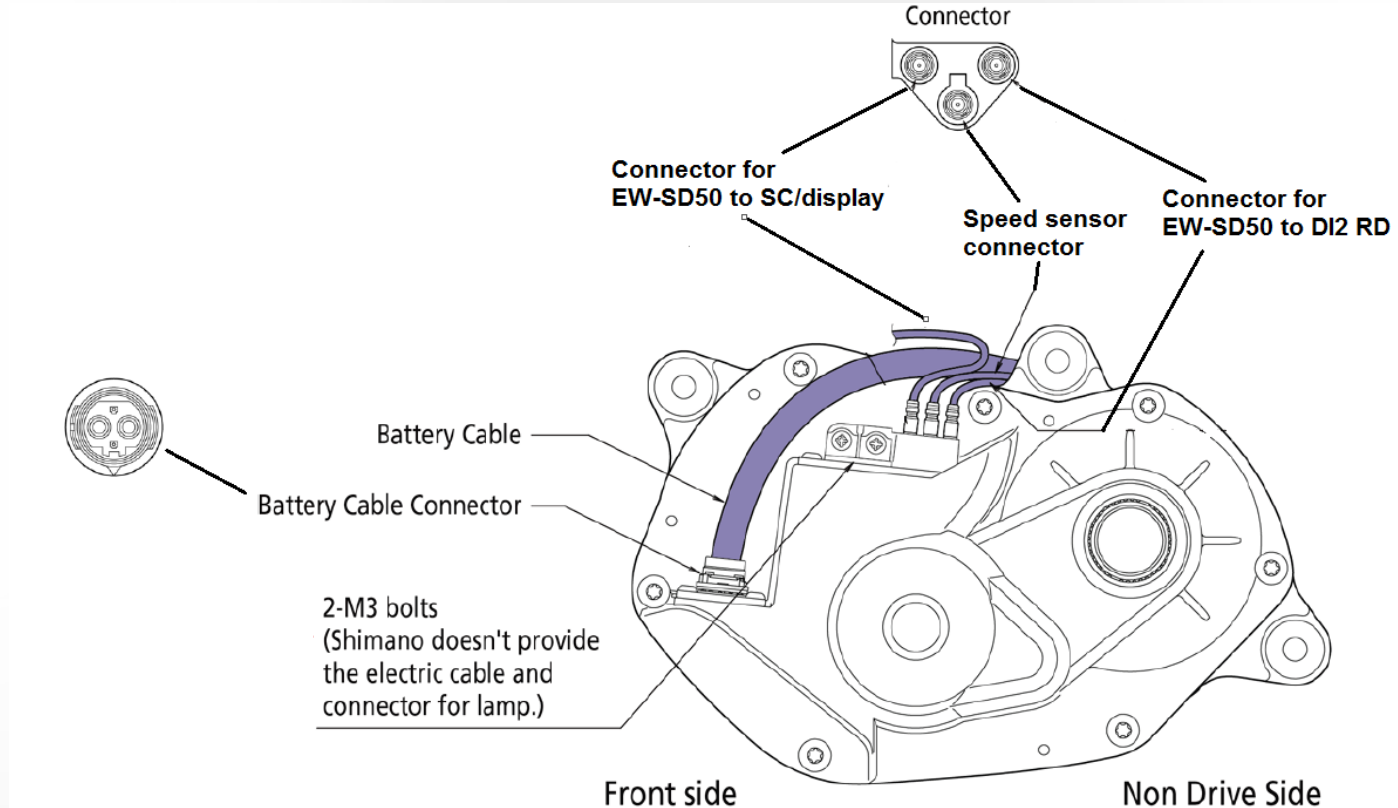

ASSEMBLY – SPEED SENSOR

SHIMANO

Mount the magnet aligned to the top of the triangle

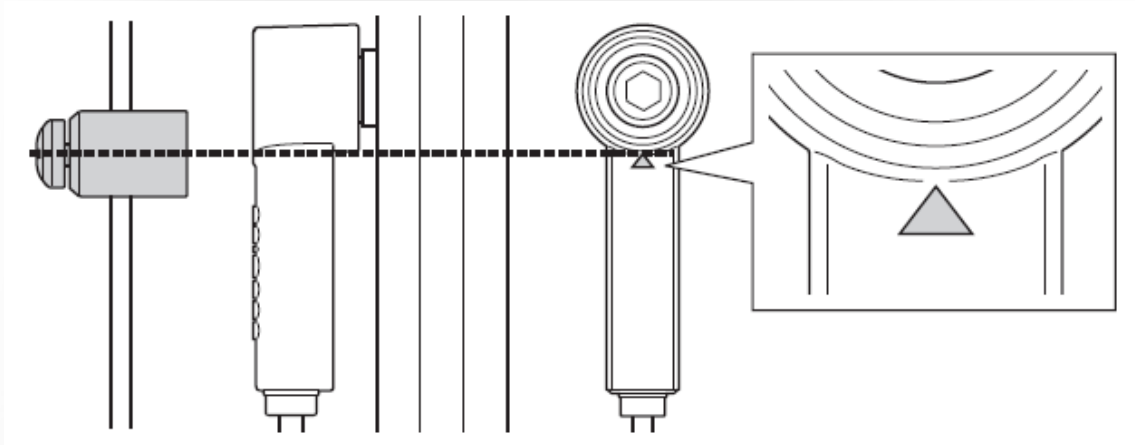

ASSEMBLY – ROUTING CABLES

SHIMANO

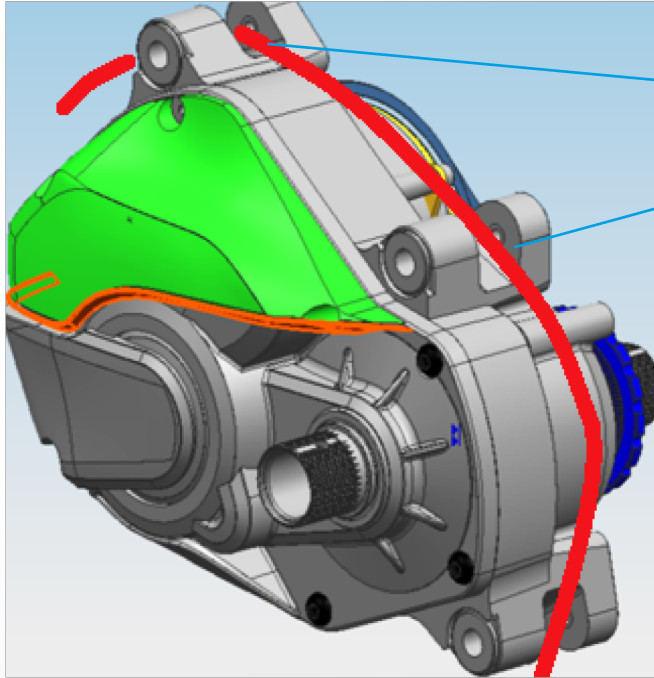

Cables can be routed between the attachment parts

ASSEMBLY – CONNECTION OF CABLES

SHIMANO

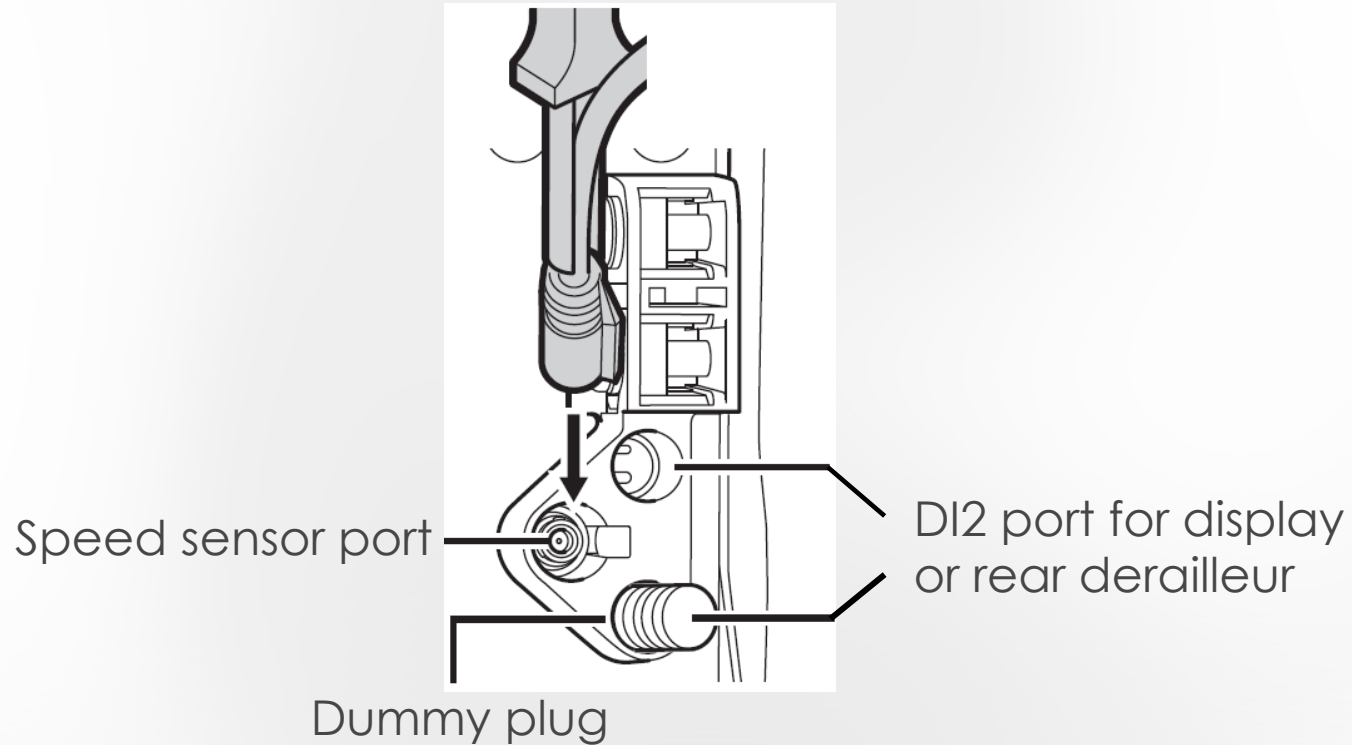

ASSEMBLY – CONNECTING THE BATTERY CABLE

SHIMANO

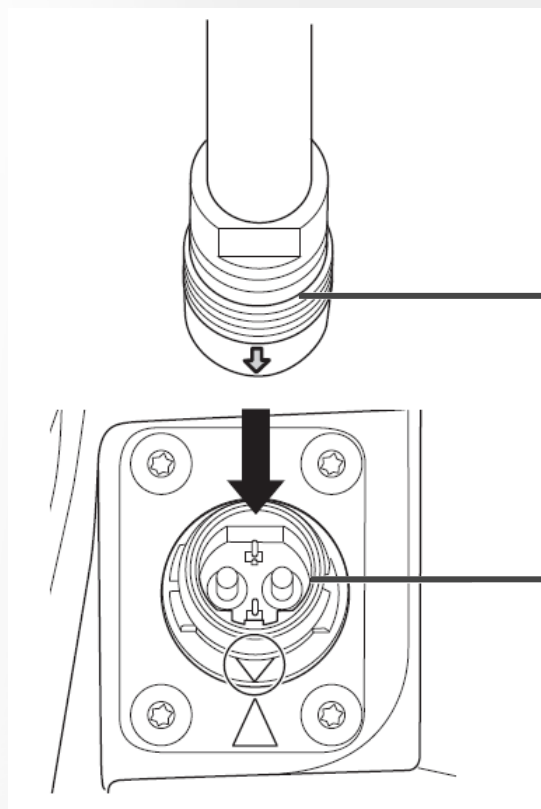

Plug of battery cable

Drive unit port

ASSEMBLY – INSTALLING THE LEFT CRANK

SHIMANO

Wide groove area

Wide part

Left crank

Axle spacer

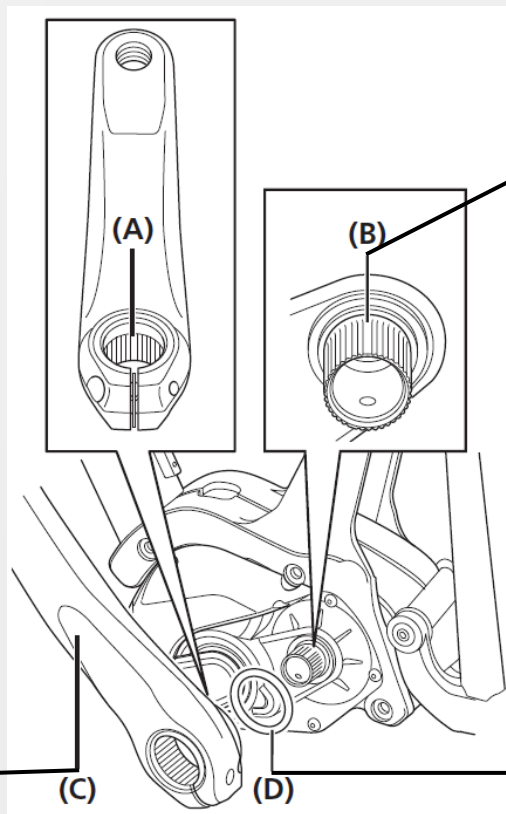

ASSEMBLY – CHAIN DEVICE WITH BACKPLATE

SHIMANO

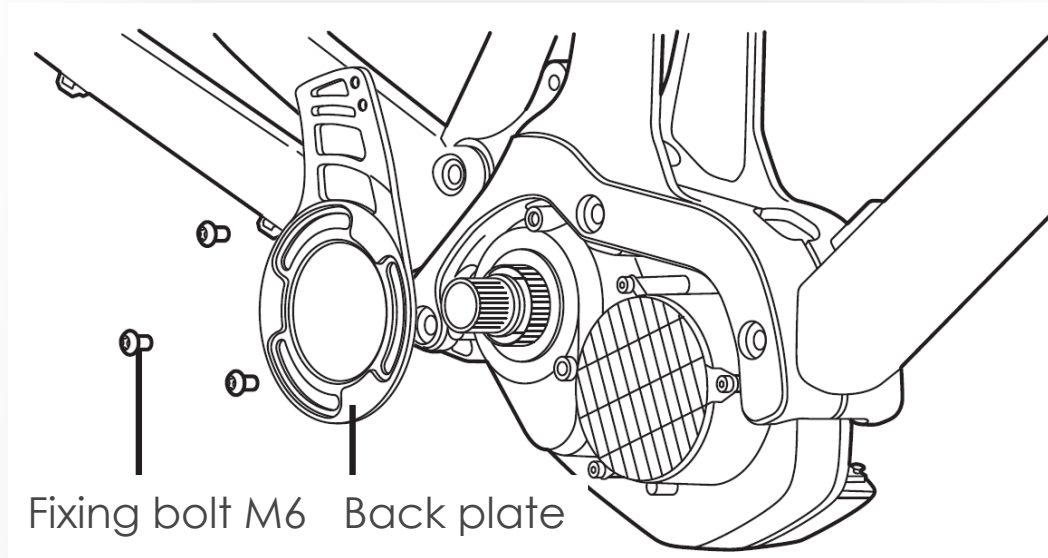

ASSEMBLY – CHAIN DEVICE WITH BACKPLATE

SHIMANO

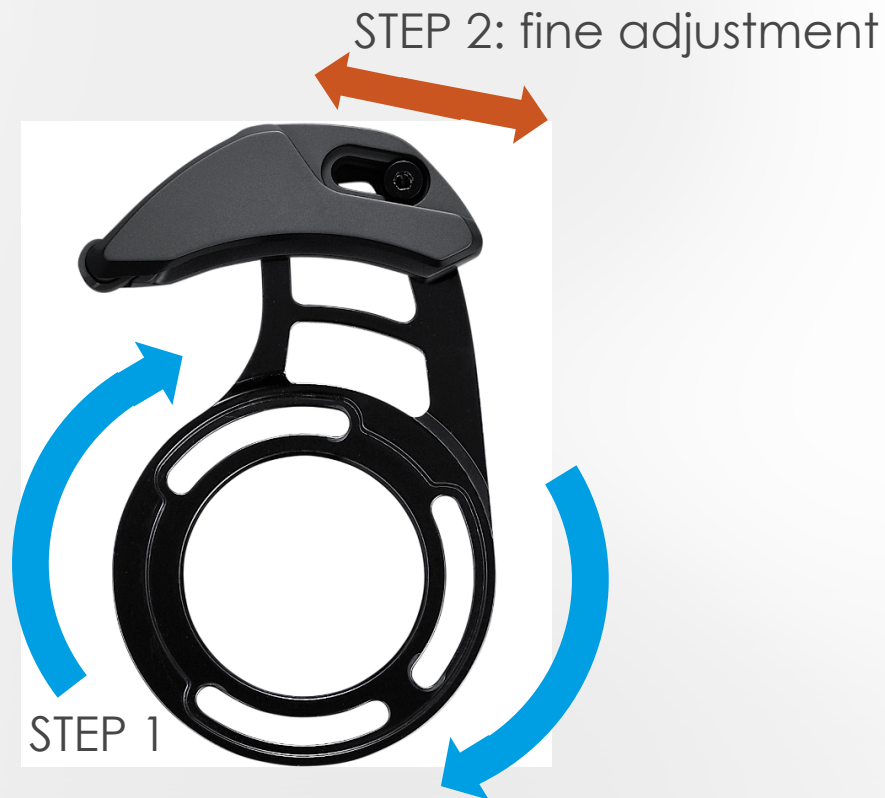

ASSEMBLY - FC AND CHAIN DEVICE

SHIMANO

- ▶ Distance (z) should be between 0 and 1 mm
- ▶ Adjustment has to be done on smallest sprocket
- ▶ Rear suspension must be completely extended

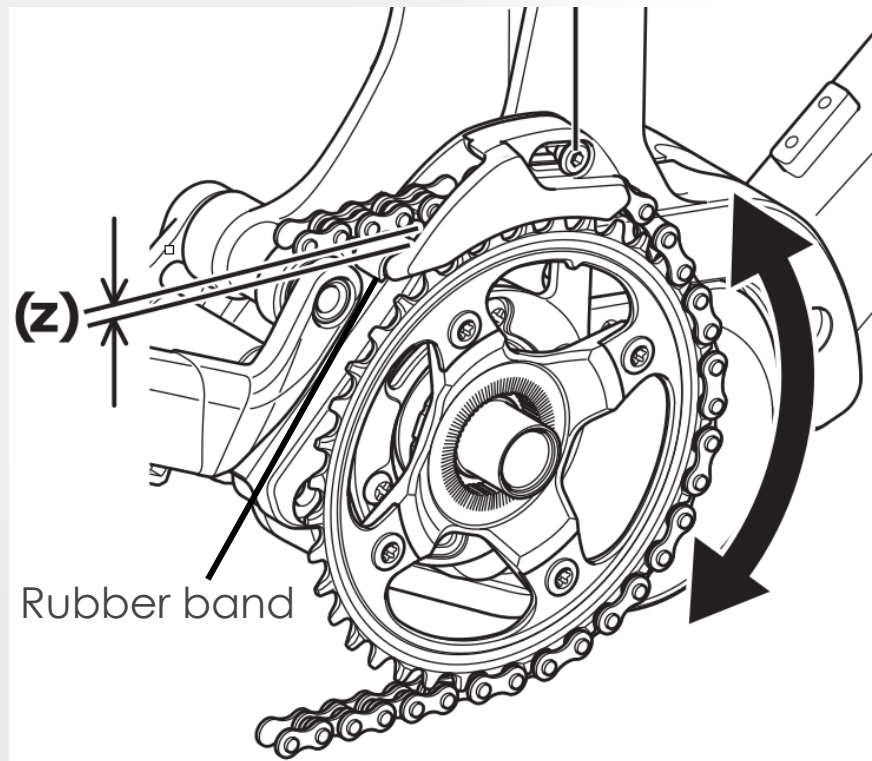

ASSEMBLY - FC AND CHAIN DEVICE

SHIMANO

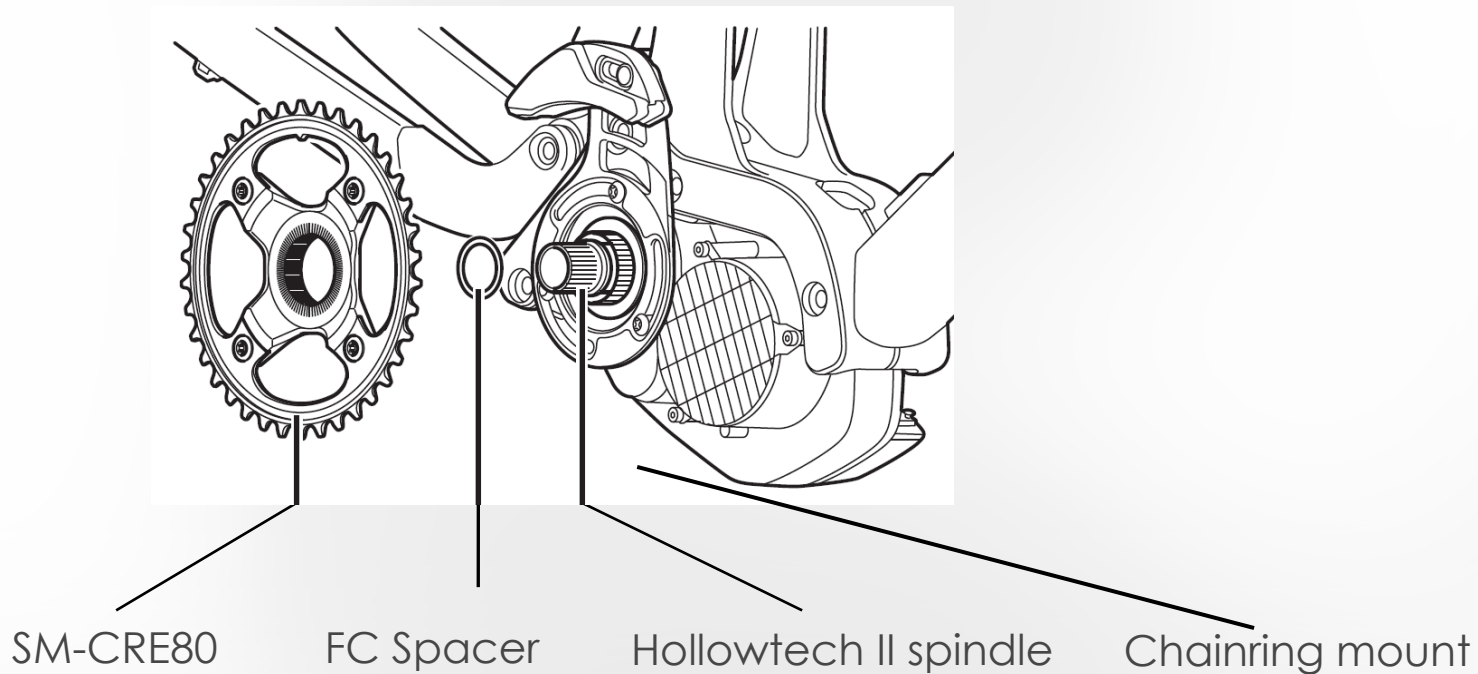

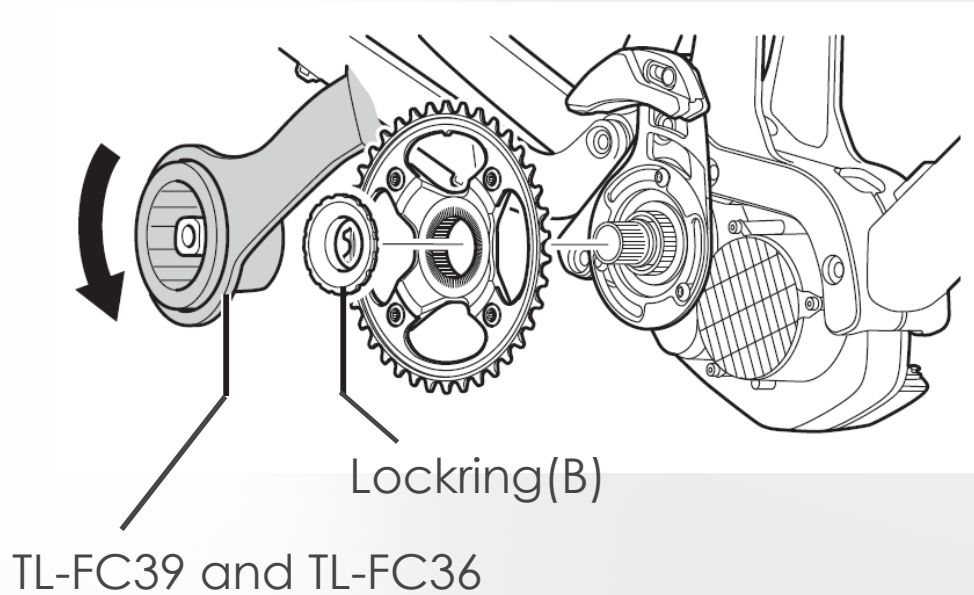

Tightening torque



35 - 45 N·m

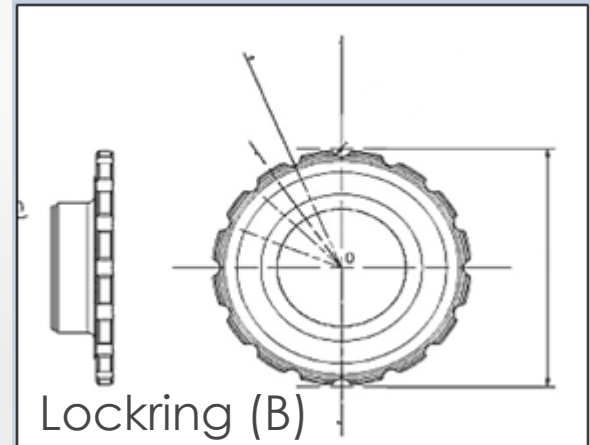

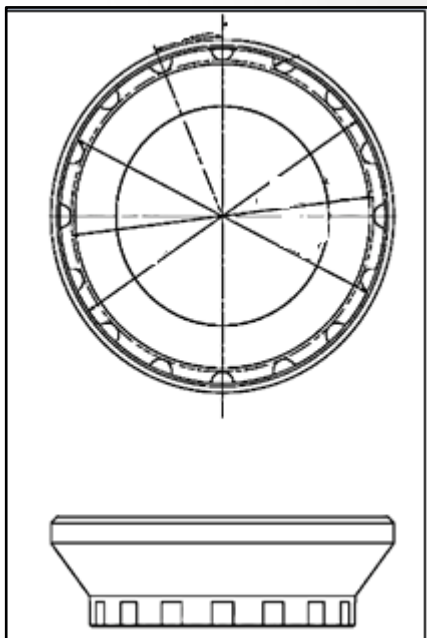

TL-FC39

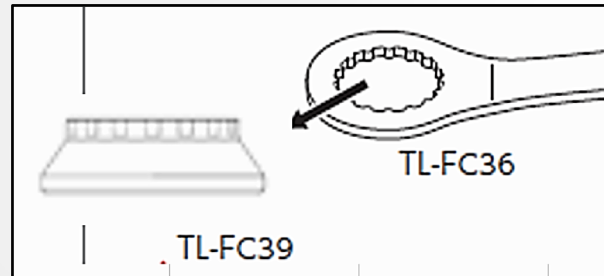

Note: TL-FC39 has different size than TL-FC38

ASSEMBLY – INSTALLING THE RIGHT CRANK

SHIMANO

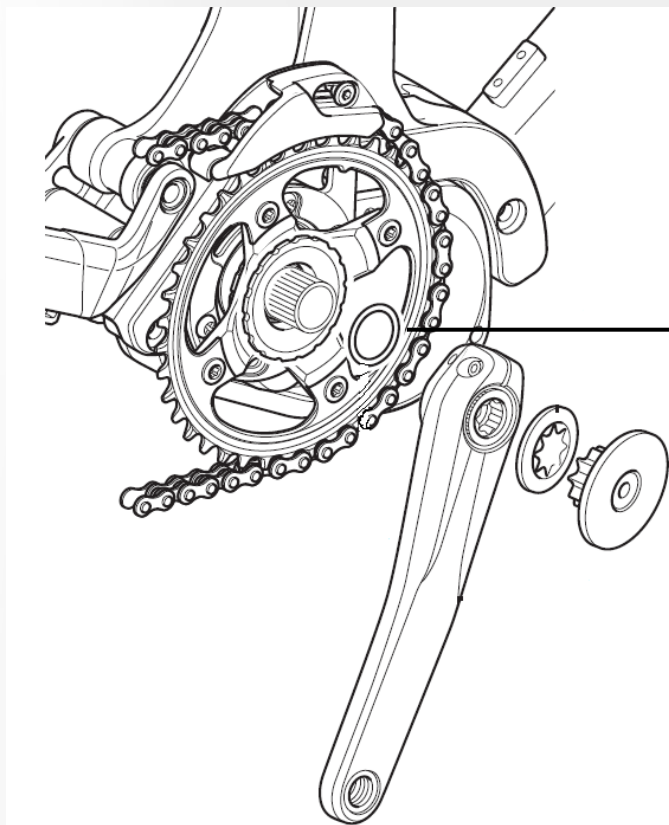

Axle spacer

ASSEMBLY – ASSEMBLY OF THE SWITCH

SHIMANO

- ▶ Adjust the positions of Lever [X1] and lever [Y1]
- ▶ Loosen the lever fixing bolt (A) using a 2mm hexagon wrench.
Adjust the lever's position so that it is easy to push.

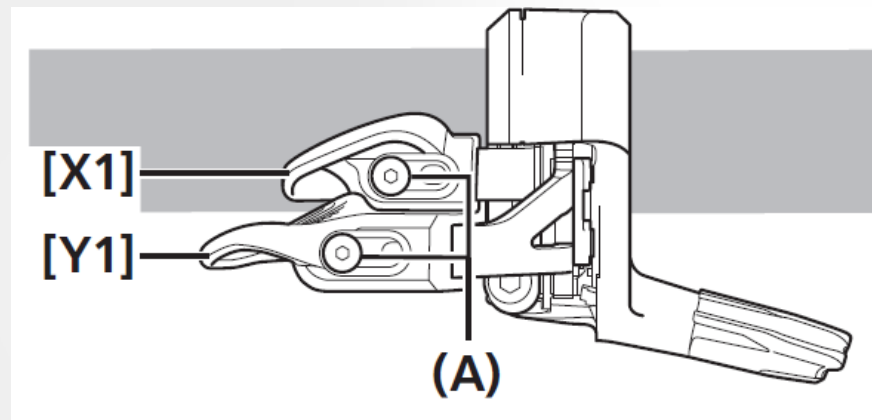

ASSEMBLY – BT-E8010 BATTERY INSTALLATION

SHIMANO

1. Insert the battery
2. Slide the battery to the right
3. Push in the battery, until you hear the click

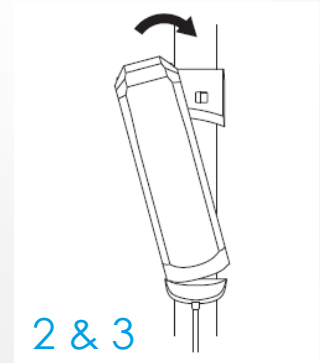
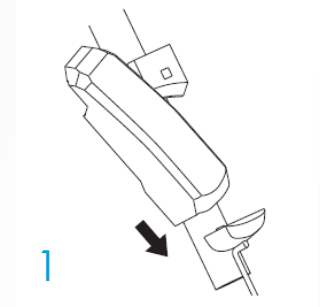

ASSEMBLY – CHARGING PORT ON THE BT-E8010

SHIMANO

- ▶ In difference to BT-E6010 there is a charging port on the BT-E8010
- ▶ Battery can be charged on and off the bike

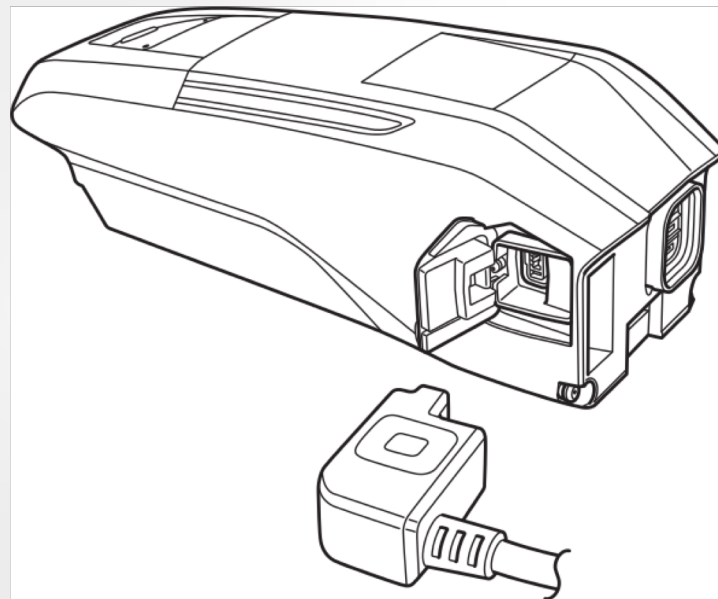







ASSEMBLY – BATTERY INDICATOR ON THE BT-E8010/BT-E8020

SHIMANO

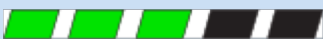
- ▶ Battery indicator shows SOC (state of charge) also, when battery is connected to the bike.



Battery level indication	Battery level
	100% - 81%
	80% - 61%
	60% - 41%
	40% - 21%
	20% - 1%
	0% (When battery is not on bicycle)
	0%, Power off / Shutdown (When battery is on bicycle)



No light



Light on



blinking

ASSEMBLY – BT-E8020 BATTERY INSTALLATION

SHIMANO

- ▶ Insert the battery into the battery mount until there is a click
- ▶ When inserted until a click is heard, the battery is locked automatically

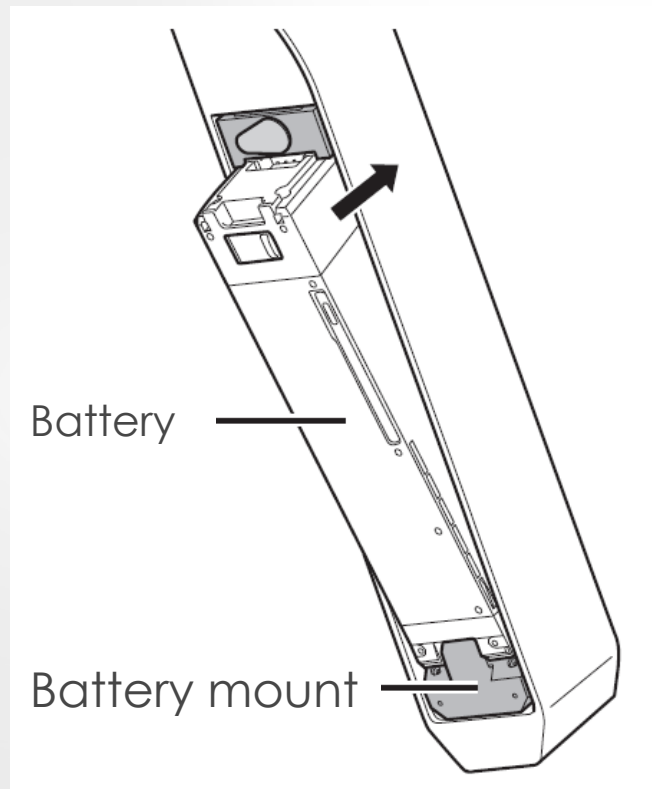

ASSEMBLY – CHARGING PORT ON THE BT-E8020

SHIMANO

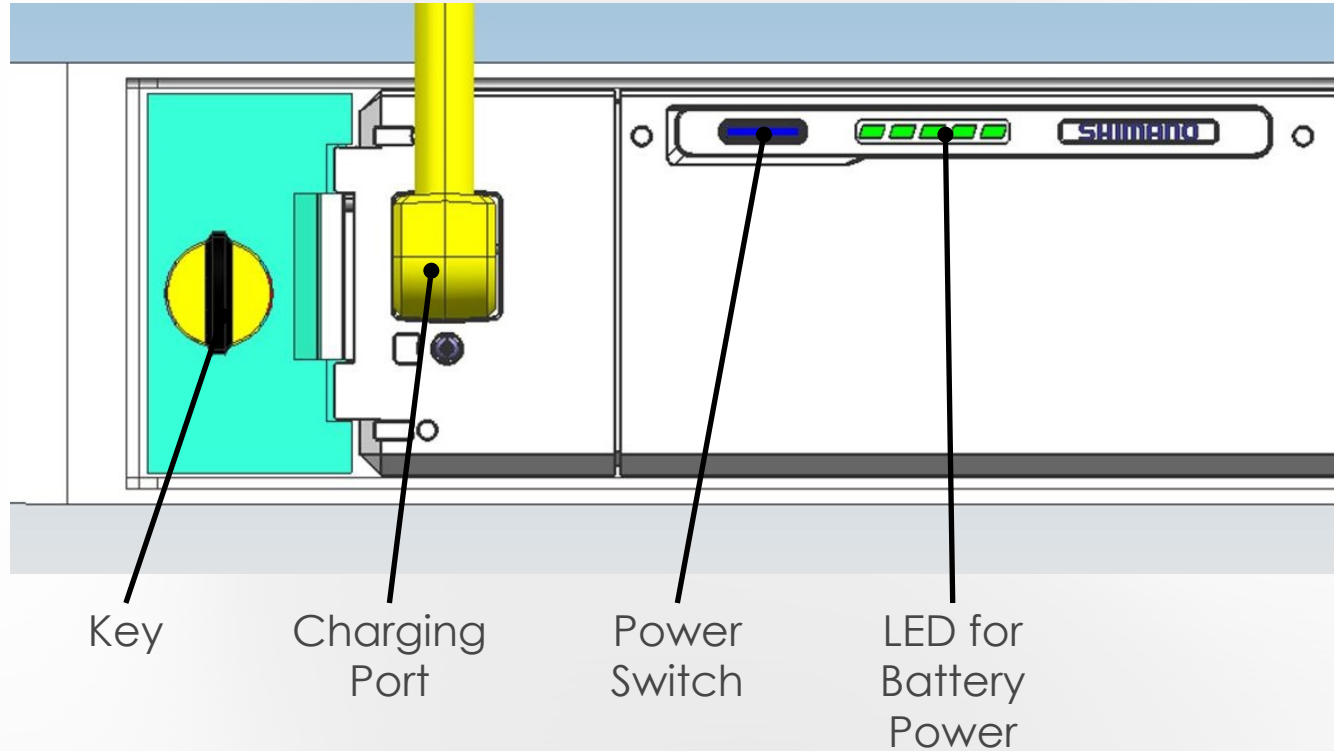

ASSEMBLY – COMPATIBILITY DRIVE UNIT

SHIMANO

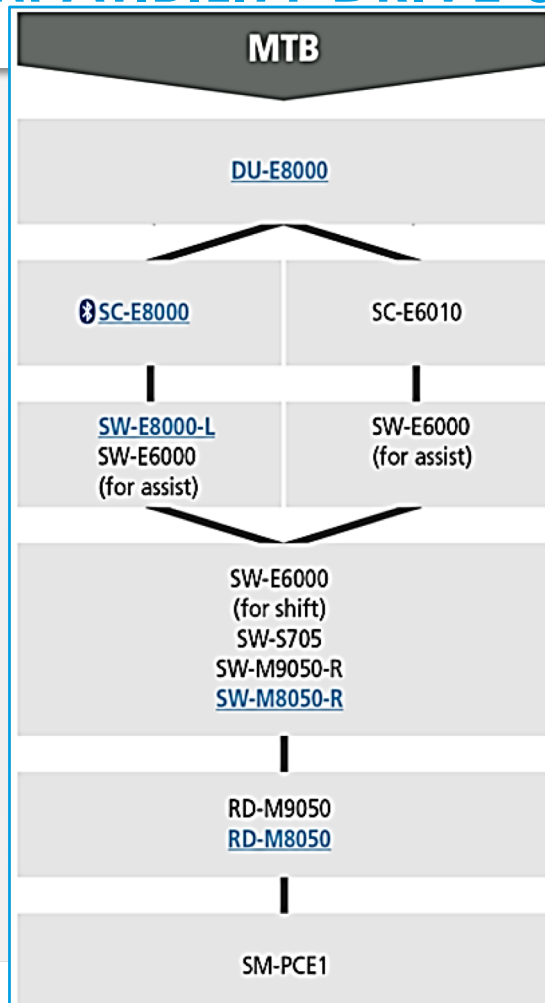

ASSEMBLY – COMPATIBILITY BATTERY

SHIMANO

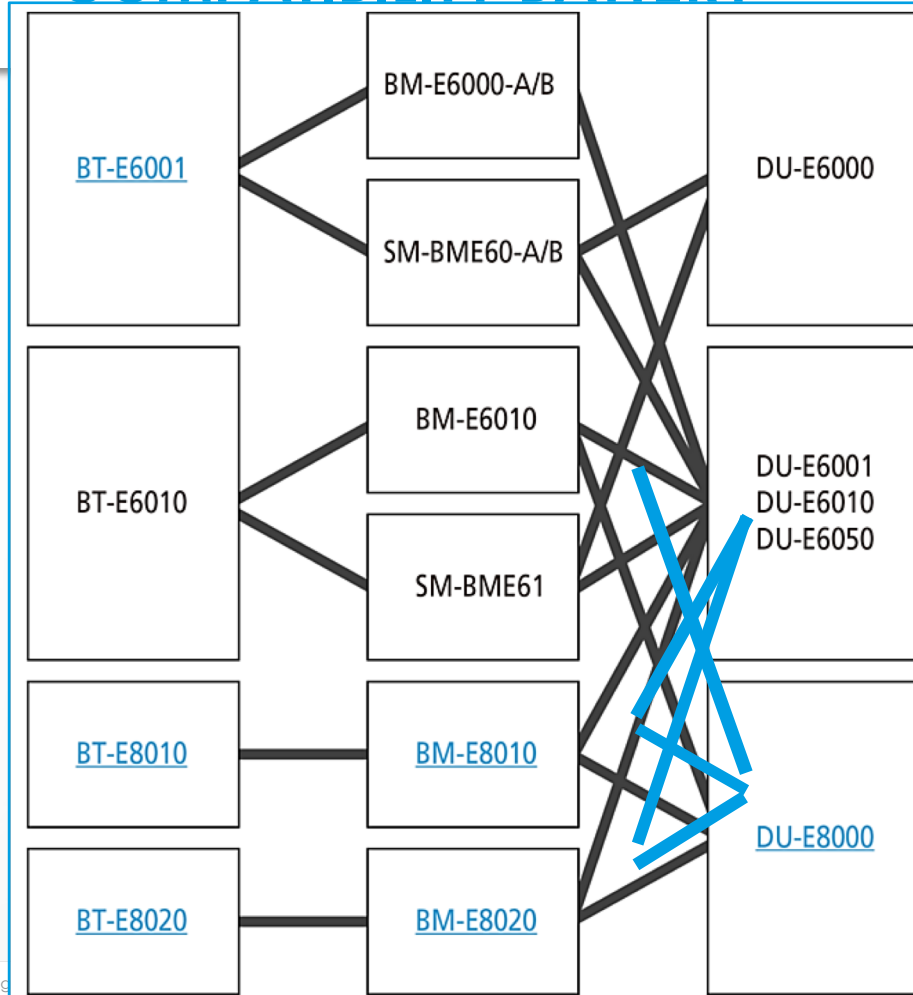

ASSEMBLY – COMPARISON SC-E6010/SC-E8000

SHIMANO

	SC-E6010	SC-E8000	Differences
	Removable	Non-removable	SC-E8000 is based on the design of SC-M9050
E-tube ports	3	4	Future expansion
LCD type	Mono-chromatic	8 color LCD	Clarify the assist mode by color display
Switches	2 (power,light)	1 (display change)	The same button structure as the XTR-Di2
Size comparison	67 x 99 x 18 mm	56.5 x 35 x 16.2 mm	
Wireless functionality	-	 Bluetooth™	Connectivity with wireless application

Assembly – drive unit

- Bolts must be at least 8 windings in the mounting portion of DU
- Frame requirement: 50 ± 0.25 mm
- Max.size of DU: 49.5 mm
- Difference is balanced by flange bushing

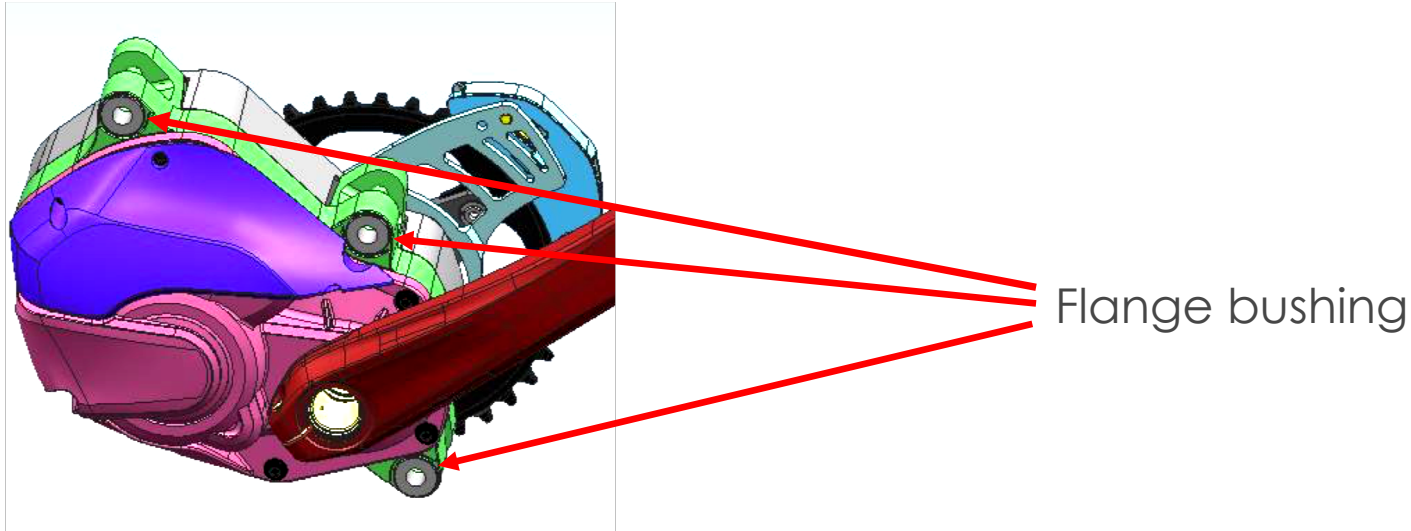

QUESTIONS?

THANK YOU!

WWW.SHIMANO-STEPS.COM