

SHIMANO

XTR M9100

14-15.11.2018



What are the core competences of new XTR

- ▶ Improved shifting performance
- ▶ Silence drive train
- ▶ Chain stability
- ▶ Durability
- ▶ Weight reduction
- ▶ Improved ergonomics (shifter)
- ▶ Powerful and controllable brakes

SHIMANO

CHAIN

XTR M9100

14-15.11.2018

4

CN-M9100

SHIMANO

- ▶ More silent
- ▶ Easy installation
- ▶ Special shaped for shifting performance and to avoid dropping from chain ring
- ▶ Directional chain

CN-M9100

XTR
SHIMANO

HG

CN-M9100



SM-CN910-12*

*Non re-usable



XTR M9100

14-15,11.2018

6

Smoother driving even over bumpy terrain

Greater chain retention to extend portion on the end of inner plate to firmly hold the tooth both front and cassette sprocket

Enhancements to shifting performance

Compatible with new generation of drive train

QUICK LINK (SM-CN910-12)

Easy connect

Quick assembly tool also available

Non-reusable

QUICK-LINK connecting & removing pliers (**TL-CN10**)

Note:

Not compatible current HG-X11 chain

QUICK-LINK connecting & removing pliers is current product

SMOOTH DRIVING TRANSMISSION

- ▶ -4 dB (vs. M9000)

EXTENDED

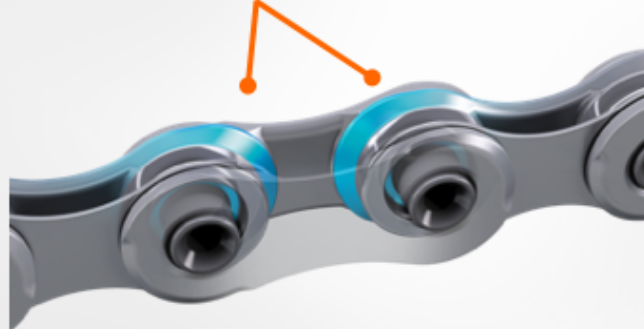

CHAIN

High holding performance CN

XTR

SHIMANO

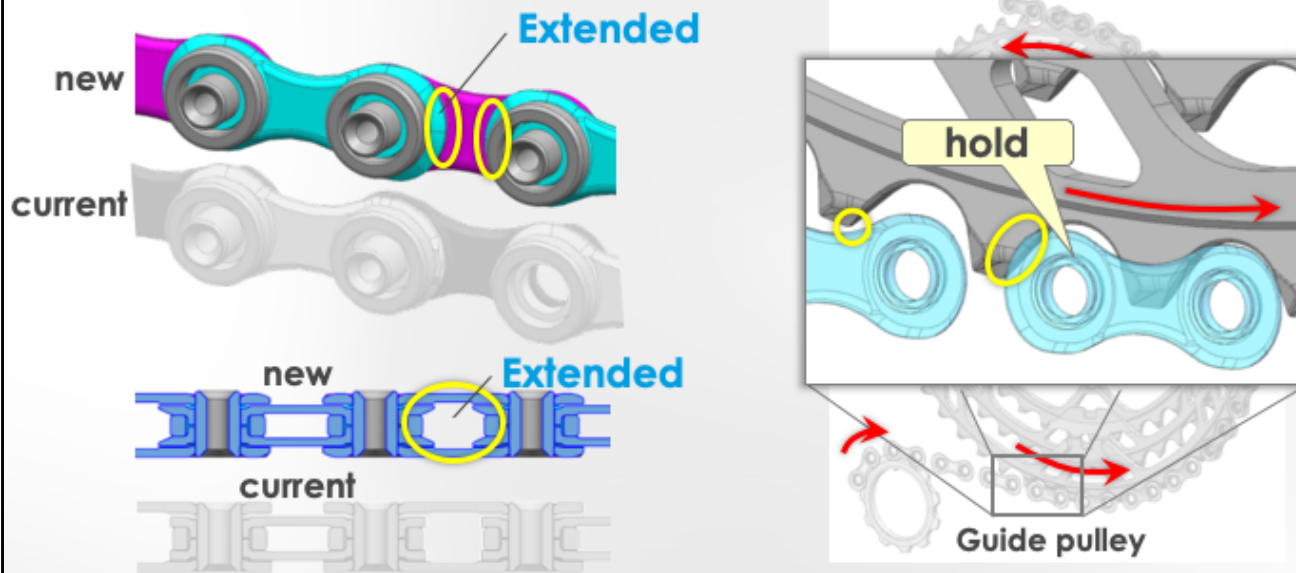

XTR M9100

14-15,11.2018

8

Smoother driving even over bumpy terrain

Greater chain retention to extend portion on the end of inner plate to firmly hold the tooth both front and cassette sprocket

Enhancements to shifting performance

Compatible with new generation of drive train

QUICK LINK (SM-CN910-12)

Easy connect

Quick assembly tool also available

Non-reusable

QUICK-LINK connecting & removing pliers (**TL-CN10**)

Note:

Not compatible current HG-X11 chain

QUICK-LINK connecting & removing pliers is current product

CN-M9100

XTR

SHIMANO

Hard to shift

CS-M9001

non Gate



CS-M9100

Easy to shift

Gate

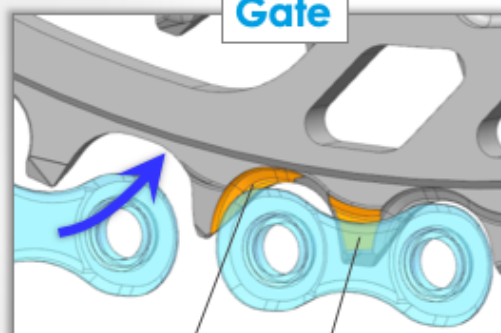

Recess
Recess

XTR M9100

14-15,11.2018

9

CRANKSET

FC-M9100

SHIMANO

- ▶ Crank arm with sandwich construction
- ▶ Easy to install chain ring
- ▶ One key release
- ▶ Special chain ring fixing nut
- ▶ Special shaped teeth
- ▶ Tool free adjustment of the axle play

FC-M9100

SHIMANO

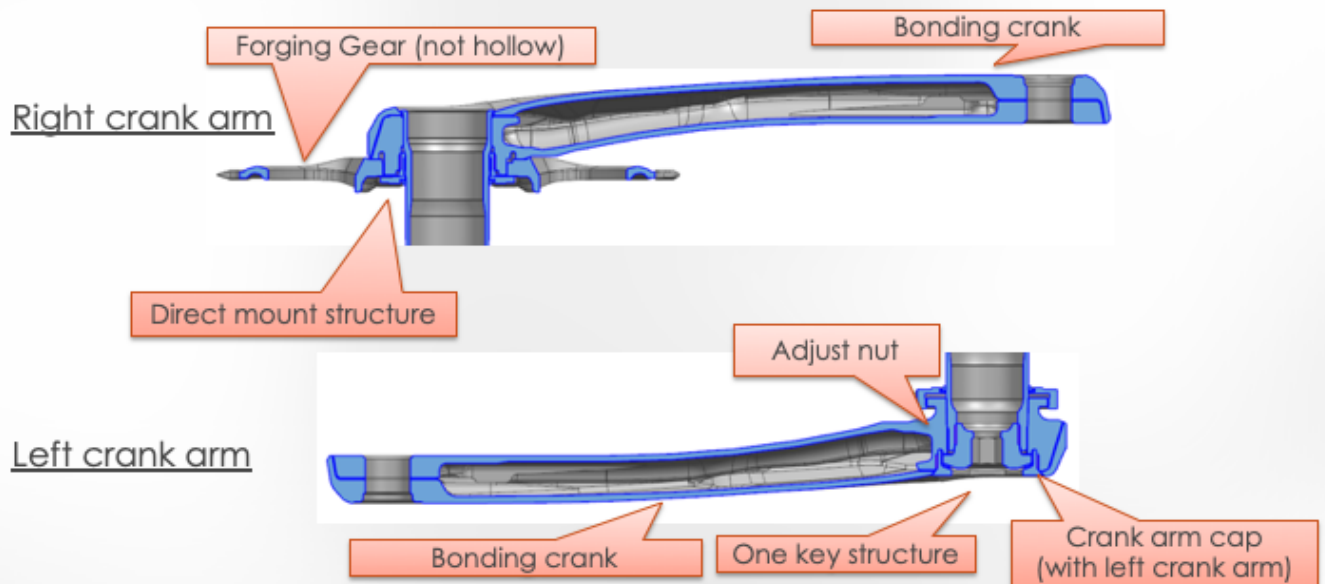

XTR M9100

14-15, 11.2018

12

FC-M9100

Tools for assembly of chain ring

XTR

SHIMANO

- ▶ Combine TLFC41 and either TLFC36 or 32mm wrench



TLFC41



TLFC36

OR



32mm WRENCH

FC-M9100

SHIMANO

Previous

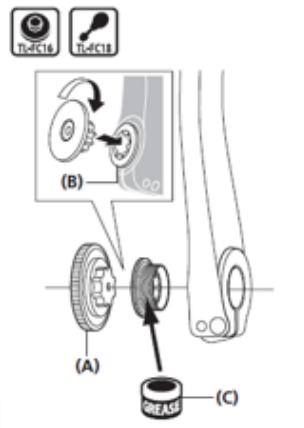

One key structure

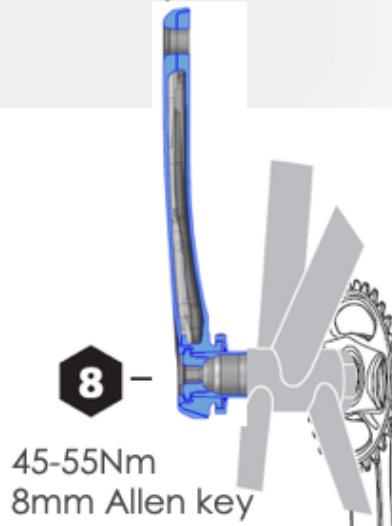

FC-M9100

XTR



**DYNAMIC
CHAIN
ENGAGEMENT**

EFFECTIVE ENGAGEMENT & SMOOTHER PEDALING

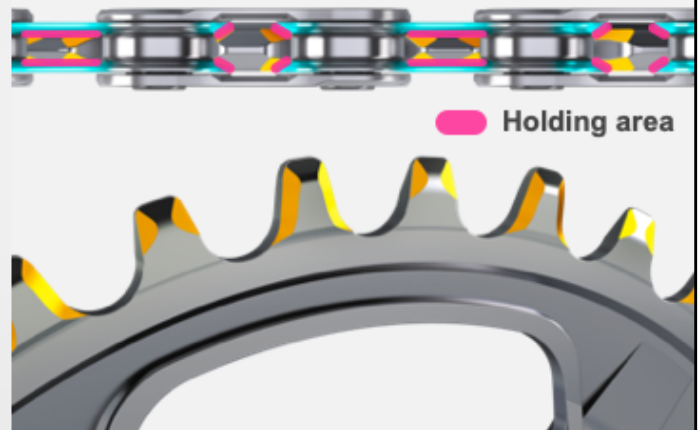

CRANKSET

Durability chainring

XTR
SHIMANO

Reduced wear out

- Hard plated

Durability improved

Hard plated

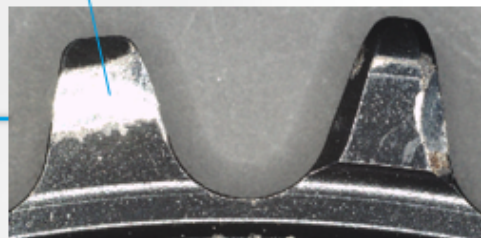

Compared to competitor

FC COMPATIBILITY

Combination new CN-M9100 and SM-CRM91



Not compatibly with 11sp chain ring

- ▶ 12 speed chain and 11 speed chain ring with Dynamic Engagement is not compatible



SHIMANO

CASSETTE

XTR M9100

14-15.11.2018

18

CS-M9100

SHIMANO

- ▶ HYPERGLIDE + shifting performance, faster and shock less
- ▶ Light weight construction
- ▶ Reduced inertia
- ▶ Easy to install

CS-M9100

XTR

SHIMANO

HYPERGLYDE+

- ▶ Let you pedal continuously while shifting



XTR M9100

14-15.11.2018

20

CS-M9100

XTR

SHIMANO

HYPERGLYDE+

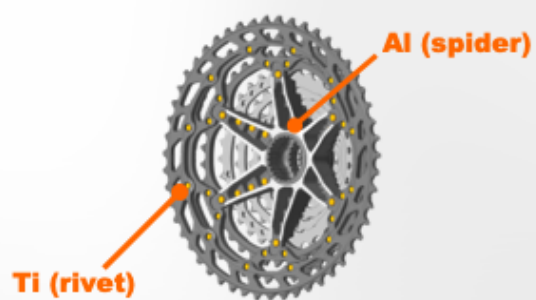

XTR M9100

14-15.11.2018

21

CS-M9100

Assembly

XTR
SHIMANO

10 and 12T sprocket have a small dot to align for correct assembly.

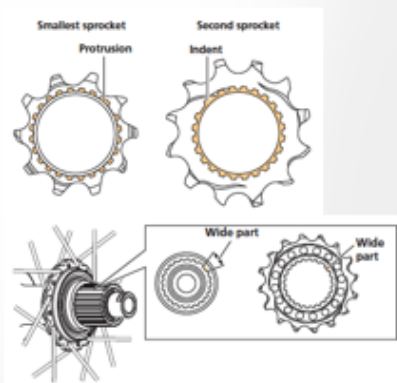

XTR M9100

14-15.11.2018

22

CS-M9100

XTR
SHIMANO

New assembly tool for easy installation



XTR M9100

14-15.11.2018

23

Reduced inertia



HUBS

- ▶ Silence drive train
- ▶ Driving rigidity improved
- ▶ Weight reduction

JUST THE
SOUNDS OF
TRAIL

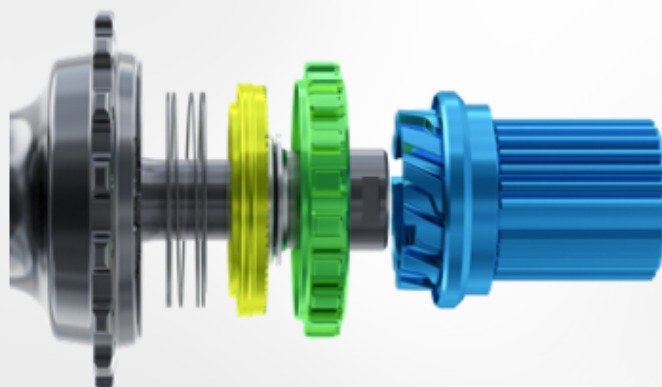

- ▶ Deformation by pedalling is 30 % less than current FH
 - Main reason is Aluminum OUTER unit

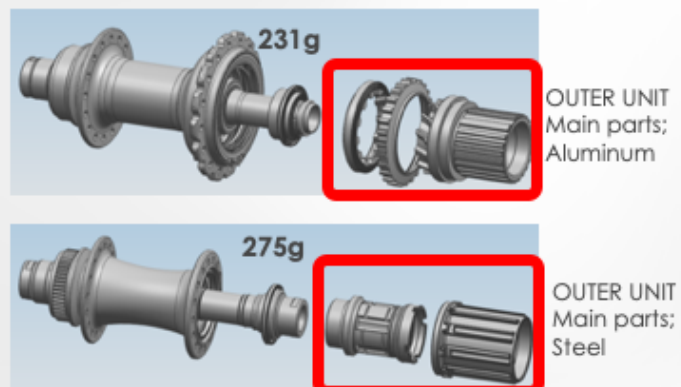

MICROSPLINE
New freehub system

XTR
SHIMANO



NEW SPLINE CONSTRUCTION

MICRO SPLINE

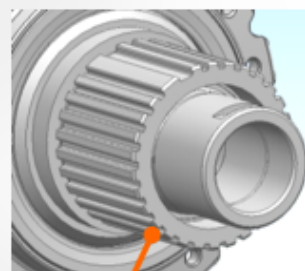

MICRO SPLINE

Alloy Free wheel body



MICRO SPLINE

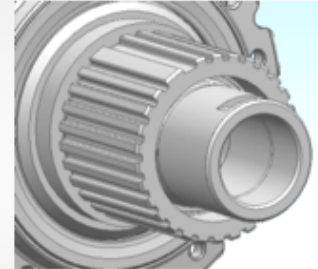

*For FH-M9125-B > only for 11sp w/micro spline

Microspline solve the damage from CS
Increase the spline teeth for reducing the
pressure to each teeth

Replaceable freewheel unit

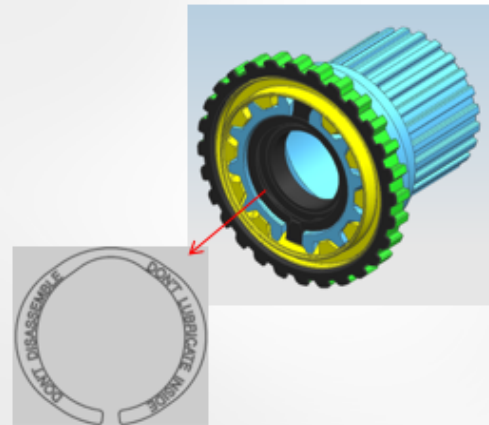

XTR M9100

14-15.11.2018

31

Offer the sub assembled unit

Replace **only** by dealer.

User cannot disassemble

1. To keep function
2. To maintain the optimum grease amount condition at factory state
3. To maintain ratchet clearance by shim adjustment

REAR DERAILLEUR

RD-M9100

SHIMANO

- ▶ Increased durability
- ▶ Decreased shifting effort
- ▶ Increased P-spring tension for better chain keeping on chain ring
- ▶ Improved GG distance
- ▶ Easy GG distance setting
- ▶ More silent

Stable pulley position

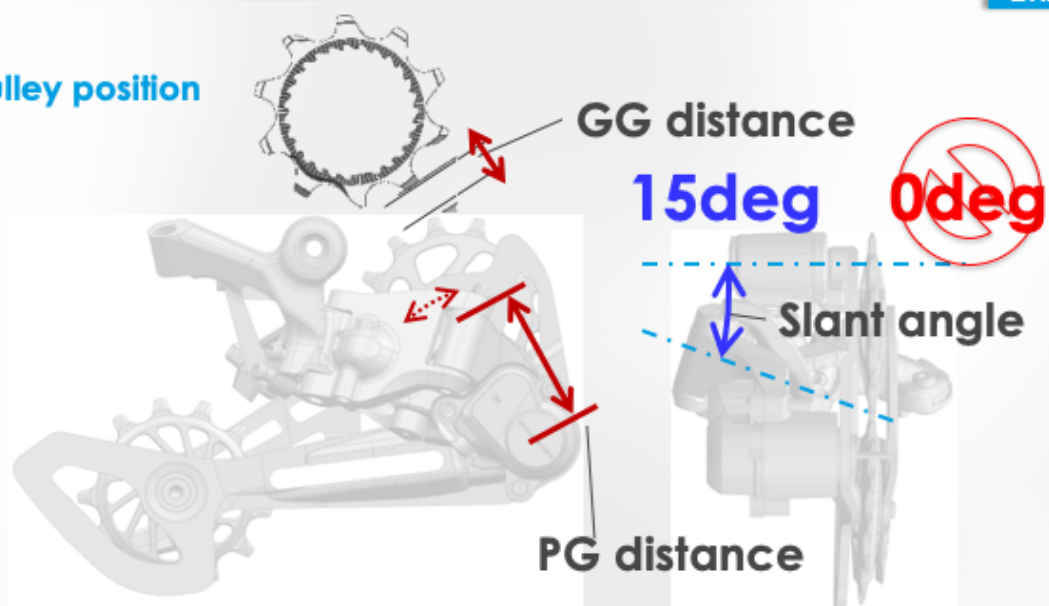

RD

Dual HYPER GLIDE

XTR

SHIMANO

Optimize the pulley path

- To maximize HG+ adjust range

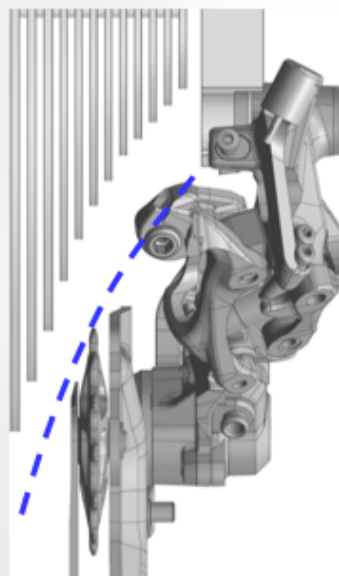

XTR M9100

14-15.11.2018

35

RD-M9120 (DOUBLE)

SHIMANO

- ▶ Increased durability
- ▶ More silent
- ▶ Improved GG distance
- ▶ Easy GG distance setting

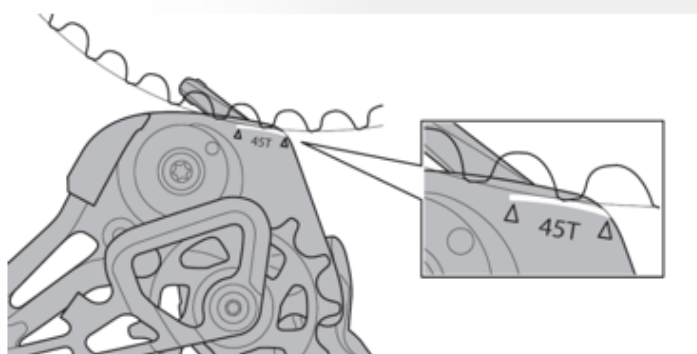

You can set the GG distance, gear to gear with the marking on the Rear Derailleur. Please refer for detail to the Dealer Manual.

Bumper

- Eliminate CN Slapping noise

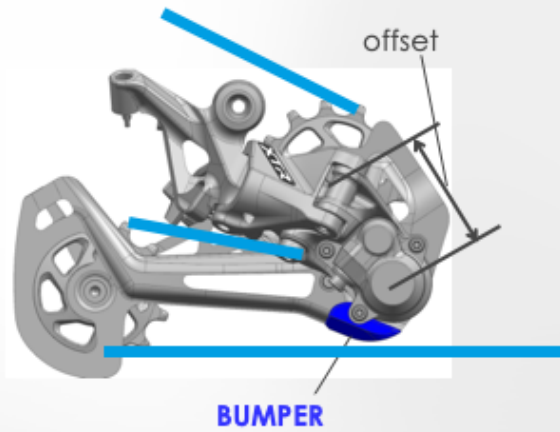

Improved outer casing stopper

- ▶ The stopper of the outer casing is modified to reduce friction of inner cable



RD

RD-M9100 and RD-M9120 SGS

XTR

SHIMANO

27 Torx bolt to adjust the chain stabilizer

RD-M9100



RD-M9120*

**Need to take off
guide pulley wheel to
adjust it.*

XTR M9100

14-15.11.2018

40

FRONT DERAILLEUR

FD-M9100-D/E/M

XTR
SHIMANO

► SIDE SWING FRONT DERAILLEUR

*SIDE SWING
Front Derailleur*

- Smooth shifting by SIDE SWING mechanism
- D, E, M mount are available
- M type mount requires adapter (Φ34.9mm)
- For 38-28T
- Adapt 48.8, 51.8 mm chain line



► FD-M9100-M

CHAIN DEVICE

SM-CD800

XTR
SHIMANO

- Easy adjustment by screw
- Light weight
- D, E, ISCG05 mount



SM-CD800 E mount



D mount type



ISCG05 type

SHIFTERS

SL-M9100

SHIMANO

- ▶ Light operation
- ▶ Improved ergonomics (shifter)
- ▶ Faster accessing time

SL-M9100-I / SL-M9100

XTR
SHIMANO

RAPIDFIRE PLUS    I-SPEC EV



XTR M9100

14-15,11.2018

47

With OPERATION TIME FASTER THAN EVER, riders can instantly adapt to rapidly-changing conditions. And Reduced shifting operation force

Riders can shave crucial tenths of seconds from each operation with intuitive, seamless and minimum movements at the fingertips.

Operation time: Glip >> Access to Shifter >> Operation >> Glip
Fine tune of shifter lever design

Quicker lever access and light operation force maintains rider concentration

20% quicker lever access time

-35% shifting operation force (vs. M9000)

Greater flexibility and action-optimized cockpit layout

I-SPEC EV

11/12-speed converter (SL-M9100-R/-IR)

OFFER BEST SETTING FOR RIDERS

95% covered

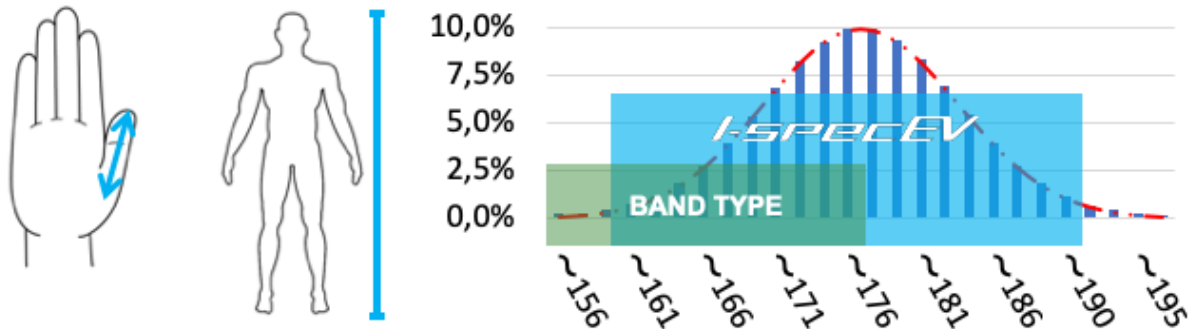

XTR M9100

14-15, 11, 2018

48

We started development of I-SPEC EV to offer best setting of brake and shifting lever for every rider and riding style.

CLICK

Important factor of the lever setting is length of rider's thumb.

We consider the size of hand from small to large

And the based of the relation between length of thumb and height

CLICK

This graph shows distribution of height

our new I-SPEC EV covers

CLICK

95% of riders

CLICK

And band type covers small hand riders

I-SPEC EV

XTR
SHIMANO

WIDER ADJUST RANGE FOR EACH RIDING STYLE

I-SPEC/EV

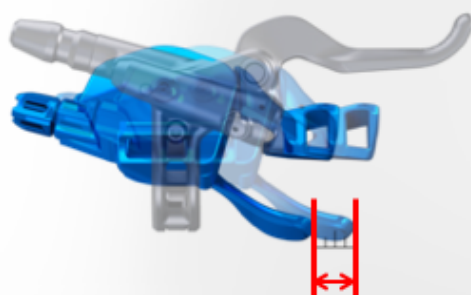

14 mm SLIDE RANGE



60° ROTATION ANGLE

SL-M9100L

SHIMANO

- ▶ Simple operation
- ▶ Improved ergonomics (shifter)
- ▶ Access point can be set to rider preference
- ▶ Faster accessing time
- ▶ Adoptable to 11S M9100 Series



For left side shift lever, we have new construction.

New MONO LEVER technology lets riders shift both up and down with a single lever.

For Lightweight and compact design

RAPIDFIRE PLUS MONO LEVER supports front double shifting with natural finger positioning and intuitive shifting operation while maintaining a solid grip on the handle bar.

2 WAY-RELEASE functionality delivers instantaneous push & pull movements.

Note

Compact design and light weight, however realized RAPIDFIRE PLUS, 2WAY RELEASE function

SL-M9100L

XTR

SHIMANO

SIMPLE FRONT CONTROL

*I-SPEC*EV

**RAPIDFIRE
PLUS**MONO



SHIFTING UP

SHIFTING DOWN

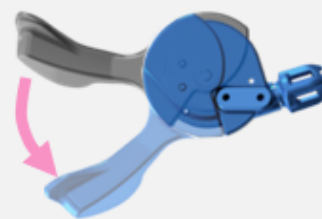
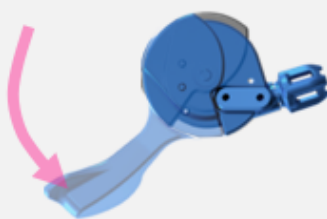

XTR M9100

14-15.11.2018

52

ASSEMBLY

SL-M9100L for double chain ring

XTR
SHIMANO

3 positions

- The lever can be positioned in 3 distances

Push and turn

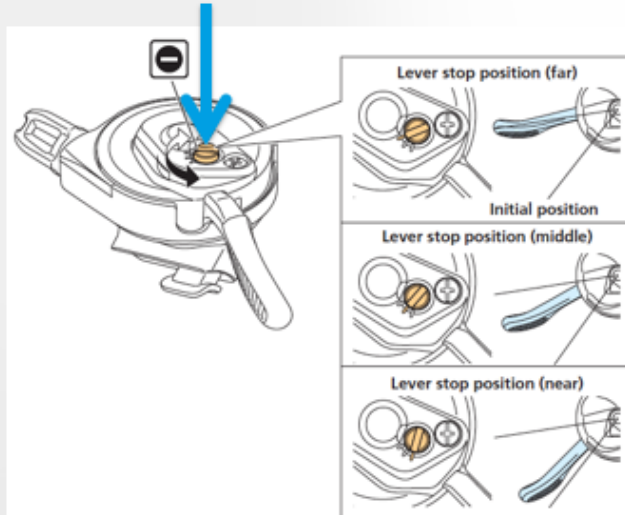

Follow the R side design concept

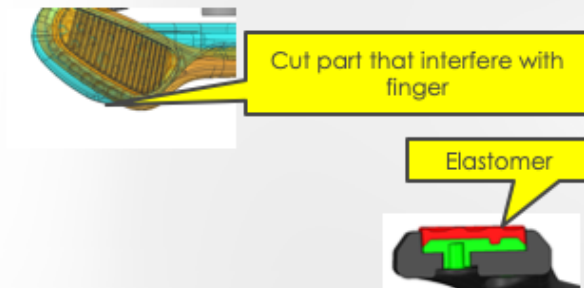

High Accessibility

Same as R side

High accuracy of operation

TOP and LOW is understood by lever position

Attaching a rubber to the operating surface(same as R)

Setting for 11 or 12 speed

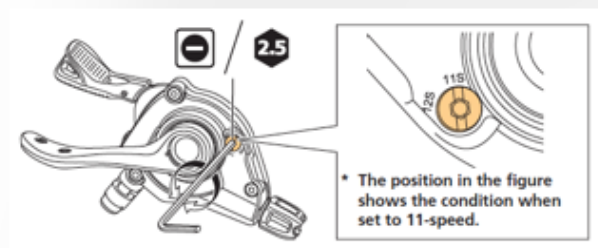

When switching from 12S to 11S, perform a release operation of one step or more with the shifting lever before turning the switch.

*Only possible with cassette that has 12 speed gear pitch.

SL-MT800-IL

SHIMANO

- ▶ Clean appearance
- ▶ Improved ergonomics I-Spec EV only
- ▶ 7 mm stroke

SL-MT800-IL

► SEAT POST LEVER

XTR
SHIMANO

I-SPEC EV



XTR M9100

14-15,11.2018

57

FASTER & EFFORTLESS OPERATION

Compatible with common adjustable seat post

FASTER & EFFORTLESS OPERATION

Quick lever access from grip position with minimum hand movement

Light operation effort by bearing

Compatible with common adjustable seat post

7 mm cable stroke

Offer I-SPEC EV type only

DISC BRAKE

DISC BRAKE XC AND ENDURO

SHIMANO

- ▶ Increased rigidity
- ▶ Weight reduction
- ▶ Increased power (4 Piston version)
- ▶ Reduced lever stroke
- ▶ I-Spec EV
- ▶ Clamp fixing bolt secured by o-ring
- ▶ Reduced friction = smoother lever operation feeling

BRAKE LEVER

XTR
SHIMANO

I-SPEC EV

NEW BRAKE STRUCTURE

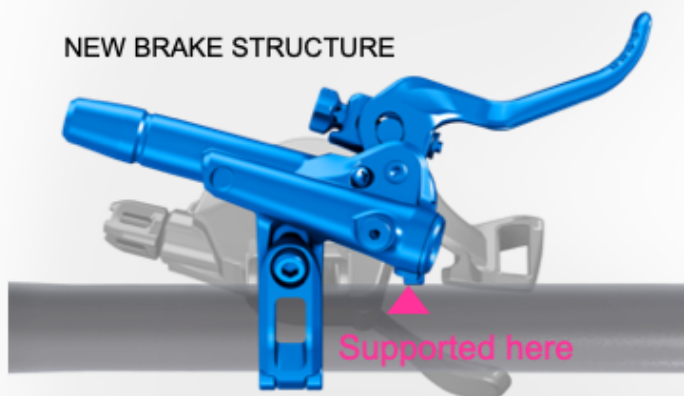

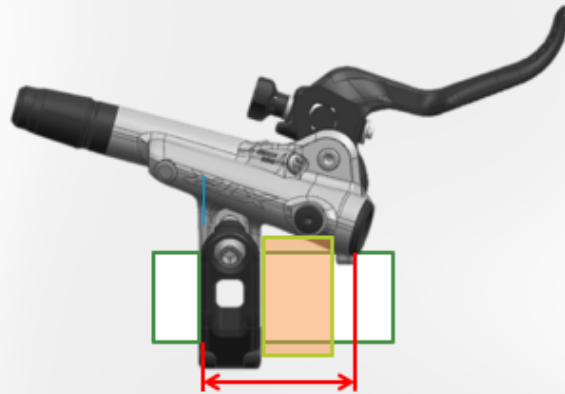

Support Leg

**■High Rigidity Structure**

M9100 115% vs M9000 (BL only)

M9120 115% vs M9020 (BL only)

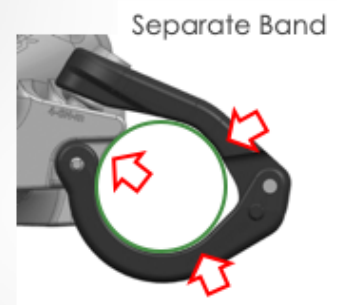
■Space of SL/ASP/SUS lever

BRAKE

Cross country

XTR

SHIMANO

I-SPEC EV



ONE WAY BLEEDING

LIGHT WEIGHT

-26g

(vs. BL/BR-M9000, RT)

HIGH RIGIDITY



10%

(vs. BL/BR-M9000, BH)



XTR M9100

14-15.11.2018

68

BL-M9120 / BR-M9120

Enduro

XTR
SHIMANO

I-SPEC EV SERVO WAVE
Action **Four
Piston**

POWERFUL

↑ **10%**

(vs. BL/BR-M9020)

HIGH RIGIDITY

↑ **8%**

IMPROVED SMOOTHNESS BY BEARING



XTR M9100

14-15, 11.2018

69

BL-M9100 / BL-M9120



- ▶ Improved clamp band fixing
- ▶ When the band is opened, the bolt fall down
- ▶ Bolt secured by O-Ring

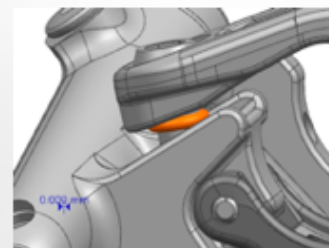

XTR M9100

14-15,11.2018

70

BL

Smooth lever feeling

XTR
SHIMANO

M9120

Current typ
Bush type

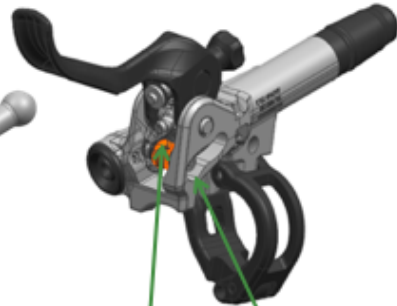

Bearing



New Servo Wave

XTR M9100

14-15,11.2018

71

New Servo Wave shape and industrial bearing for Servo Wave.
Industrial bearing BL too.

BL-9100

Smooth lever feeling

XTR
SHIMANO



XTR M9100

14-15,11.2018

72

New Servo Wave shape and industrial bearing for Servo Wave.
Industrial bearing BL too.



BRAKE CALIPER

DISC BRAKE XC AND ENDURO

SHIMANO

- ▶ Increased rigidity
- ▶ Weight reduction
- ▶ Increased power (4 Piston version)
- ▶ Flat Mount brake pad used (XC version)

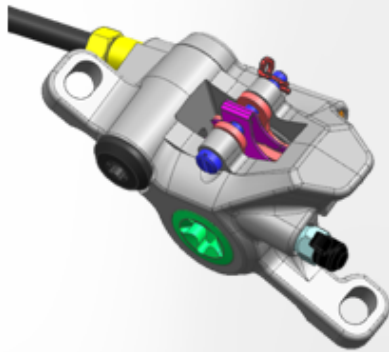

Oil flow

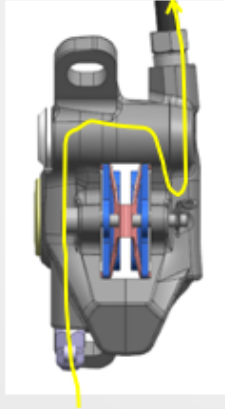

XTR M9100

14-15,11.2018

76

Freestroke reduced
Weight reduced from

Small brake pad, same as BR-R9170
Straight connection of hose
System Rigidity increased +10 %
Low profile cap
Reduced Free stroke of BL
LPC in cold condition improved



XTR M9100

14-15.11.2018

77

Reduced Free Stroke of BL. From 22,3 to 20 mm.

System rigidity increased +10 %

Reduced Free stroke of BL

ROTOR & BRAKE PADS

DISC ROTOR AND BRAKE PADS

SHIMANO

- ▶ Reduced weight
- ▶ Improved heat management
- ▶ Flat Mount brake pad used (small, only XC version)
- ▶ Improved durability of small brake pad

RT-MT900

XTR
SHIMANO

	RT99	MT900
L size (203 mm)	178.31 g	146.19 g
M size (180 mm)	137.11 g	131.34 g
S size (160 mm)	121.18 g	106.30 g
SS size 140 mm	99.55 g	89.08 g



SM-RT900

XTR
SHIMANO

RAPID COOLING & LIGHT WEIGHT

ICE
TECHNOLOGIES
FREEZA

-20°C

(203 mm rotor, vs. M9000)

-10g

(160 mm rotor, vs. M9000)



XTR M9100

14-15,11.2018

81