



Retail training MY2020

enviolo

Evolution

enviolo

2007



Fallbrook Technologies is founded, first bicycle CVP prototypes built, other fields explored, the N170™

2010



Introduction of the N360™ CVP

2011



Introduction of the Automatic transmission

2014



Introduction of the Automatic+ transmission

Evolution

enviolo

2015



Introduction of new Manual and Automatic products, new CVPs (N330™/N380™) and new controllers (C3™, C8™, C8s™, H3™, H8™)

2017



Introduction of the N330f™ and N380x™

2018



Introduction of the new division brand 'enviolo'; Winner - Bicycle Brand of the Year, awarded by the German Design Council

2019



Introduction of the new automatic shifting product: enviolo AUTOMATiQ

Bike Division - enviolo

enviolo

- **100+** OEM brands are using our internal gear hubs
- **600.000+** customers on enviolo equipped bikes
- **25+%** year over year growth over past 3 years
- **20.000.000+** rides per year for product validation





Core technology

enviolo

enviolo



A close-up photograph of a bicycle's rear hub area. A black, rectangular motor housing is mounted on the hub, featuring the 'enviolo AUTOMATiQ' logo. The motor is connected to a red frame. A silver-colored disc brake rotor is visible behind the motor. The background shows the spokes of the rear wheel and the chain drive.

enviolo
AUTOMATiQ

enviolo

Product introduction

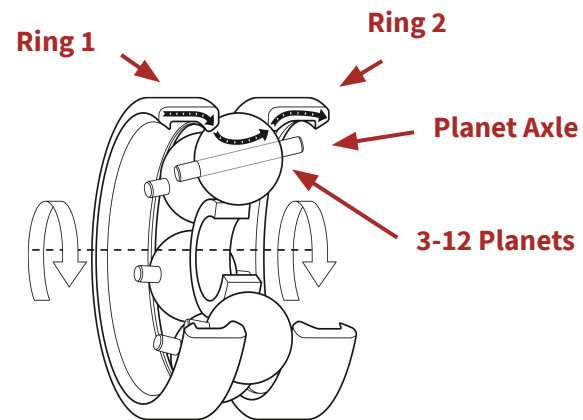
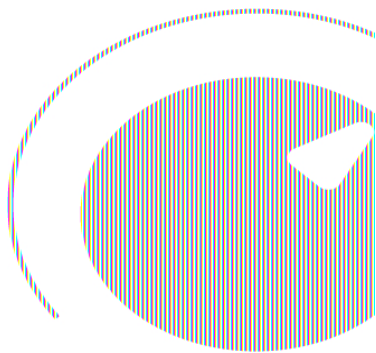

AUTOMATiQ

enviolo

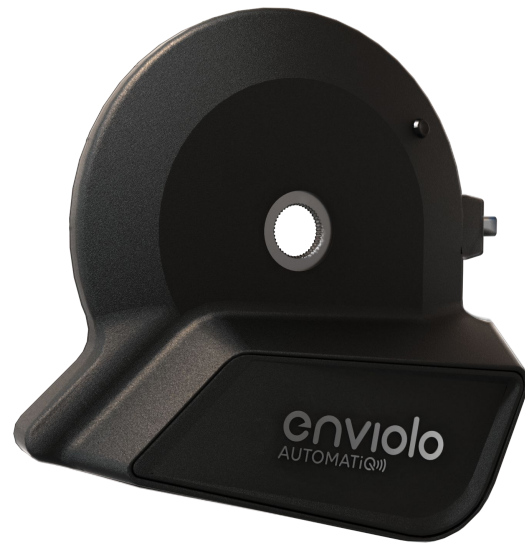
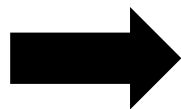
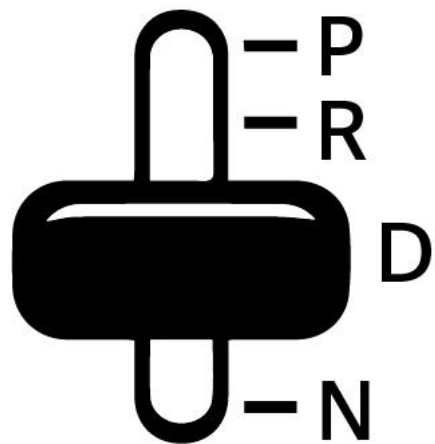

Groupsets for 5 product applications

enviolo

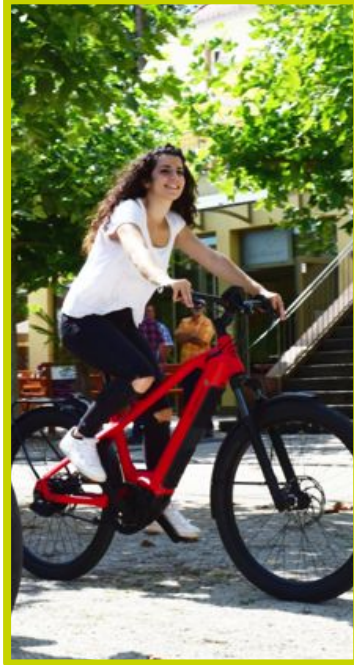



enviolo[®]

created as a city groupset
perfectly designed for the
demands of the urban bike and
the urban rider.



enviolo^{TR}



A trekking groupset designed to offer the technical performance suitable for longer rides.

enviolo^{SP}



The sportive groupset provides sportive riders with the agility and product performance they desire.

enviolo^{CA}



**We designed a cargo groupset,
perfectly developed to manage
higher loads.**



enviolo^{co}

We designed a commercial groupset
that enables riders to have a simple and
worry-free ride – always.

Schaltgruppen für 4 Anwendungen

enviolo

City

Ratio range:

310% (0.55 – 1.7)

Max. continuous torque:

50 Nm

Max. peak torque:

80 Nm

Max. vehicle weight:

160 kg

Trekking

Ratio range:

380% (0.5-1.9)

Max. continuous torque:

75Nm

Max. peak torque:

90Nm

Max. vehicle weight:

180kg

Cargo

Ratio range:

380% (0.5-1.9)

Max. continuous torque:

100Nm

Max. peak torque:

100Nm

Max. vehicle weight:

280kg

Sportive

Ratio range:

380% (0.5-1.9)

Max. continuous torque:

120Nm

Max. peak torque:

120Nm

Max. vehicle weight:

280kg

Controllers

enviolo

City



Trekking



Cargo



Sportive



Manual Hub Interfaces

enviolo

2019

enviolo CT



enviolo TR



enviolo CA



enviolo SP



2020

enviolo CT, TR
Multi-turn



enviolo CT, TR
One-turn



enviolo CA, SP
Multi-turn



enviolo CA, SP
One-turn





Warum enviolo?

enviolo

Rider benefits

enviolo

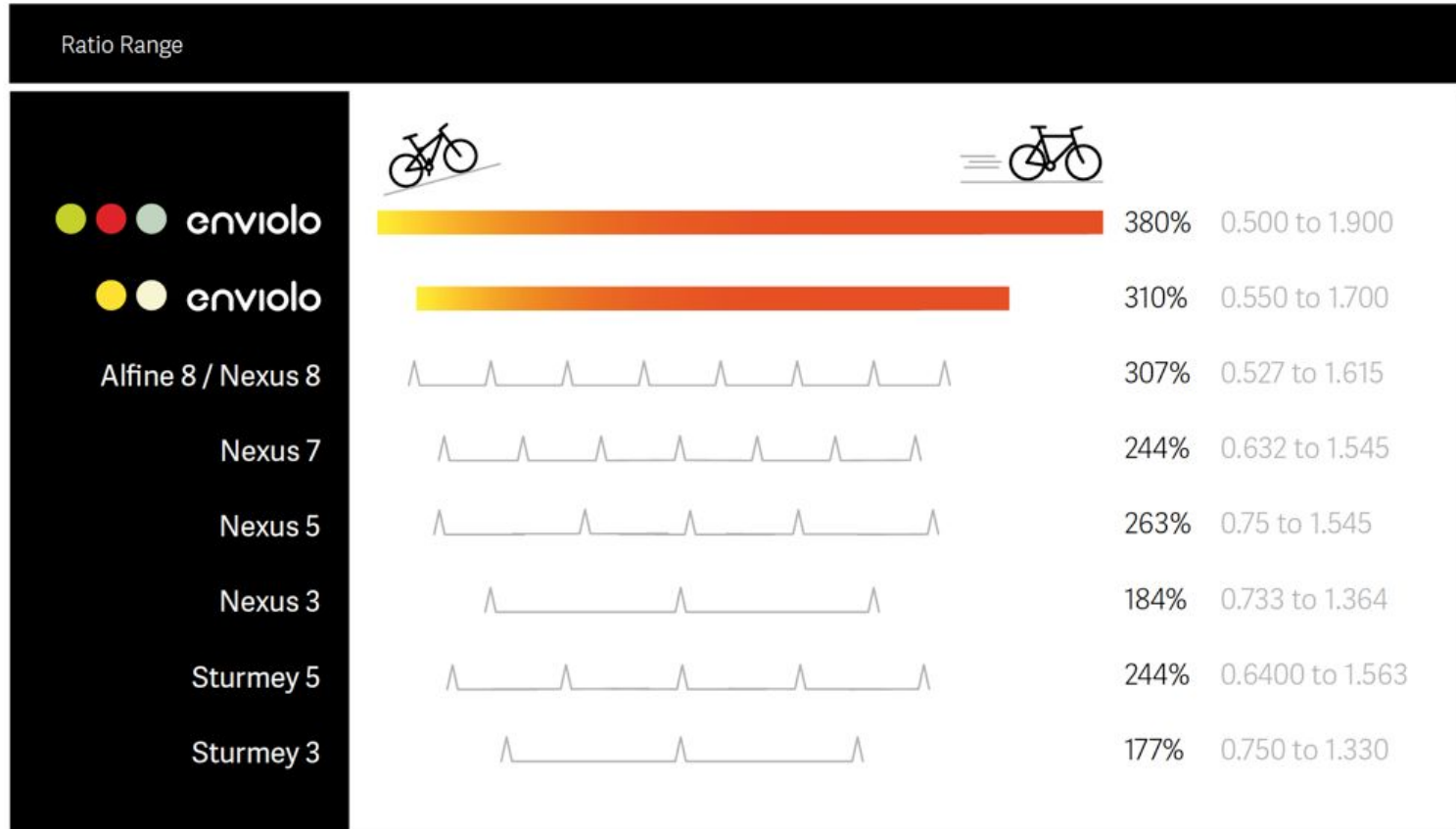



Stepless shifting

– as simple as
adjusting the volume
on a radio.



Near
silent



Stepless
shifting

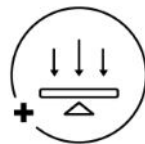

Effortless shifting,
even under load

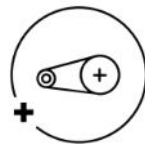

Greater gear
ratio range

Fahrervorteile

enviolo

Automatic shifting

– why bother switching
gears manually?



Near
silent

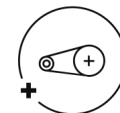

Greater gear
ratio range

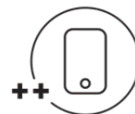

Mobile App
Customization

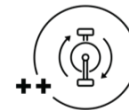

Comfortable pedaling
at your desired
cadence



Stepless
shifting



Effortless shifting,
even under load



No additional
shifter



Wireless
Connection

Benefits for retailers

enviolo



Differentiating your portfolio



Higher margins



Less maintenance & service

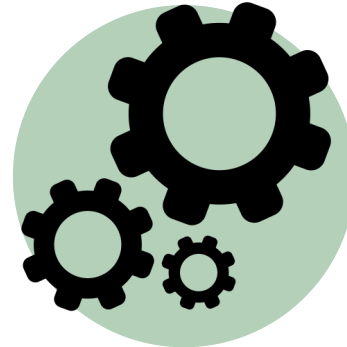

New customers



enviolo

Introducing the new
enviolo product portfolio.

Groupsets specifically designed
for unique use cases.

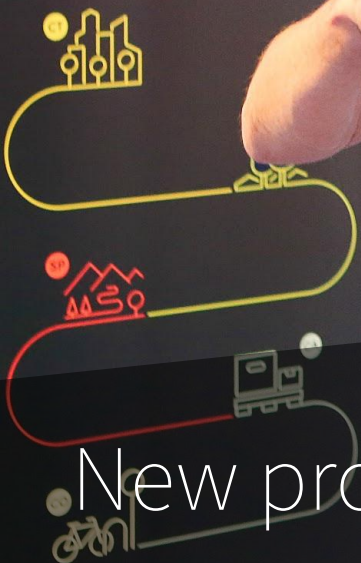

New products



enviolo

enviolo

Shift cable indication

enviolo

Article #

All manual controllers

Adjustment

Color coding on the underdrive shift cable

Availability

In mass production

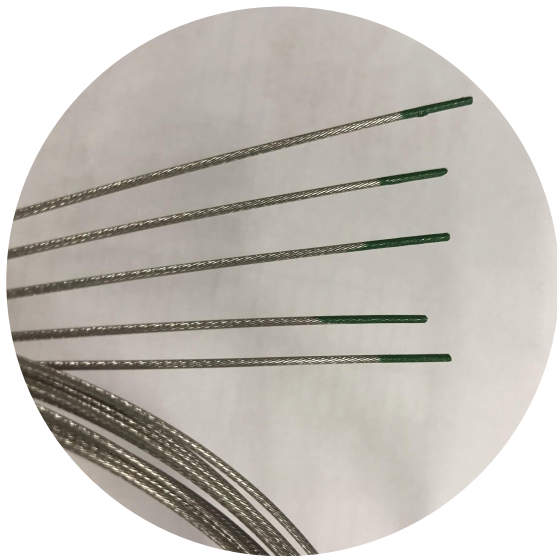

Replacement grip

enviolo

<i>Full Part #</i>	MC-CO/CA-GRIP-OE
--------------------	------------------

<i>Grip material</i>	Improved rubber
----------------------	-----------------

<i>Compatible with</i>	enviolo CT/CO/TR/CA
------------------------	---------------------

<i>Availability</i>	In stock
---------------------	----------

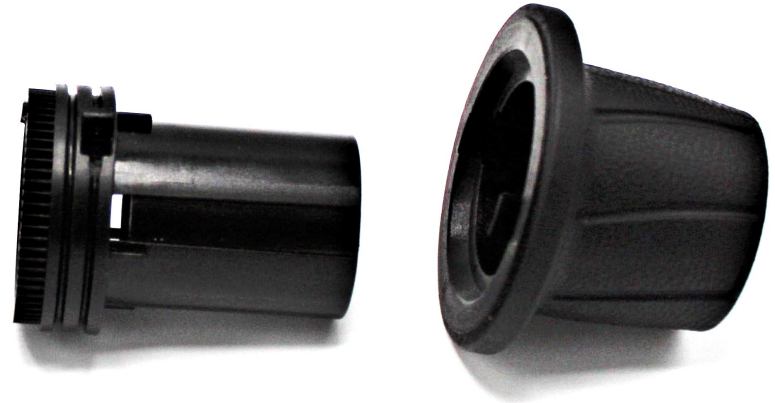



enviolo

Assembly - Manual

Replace shift cable

enviolo

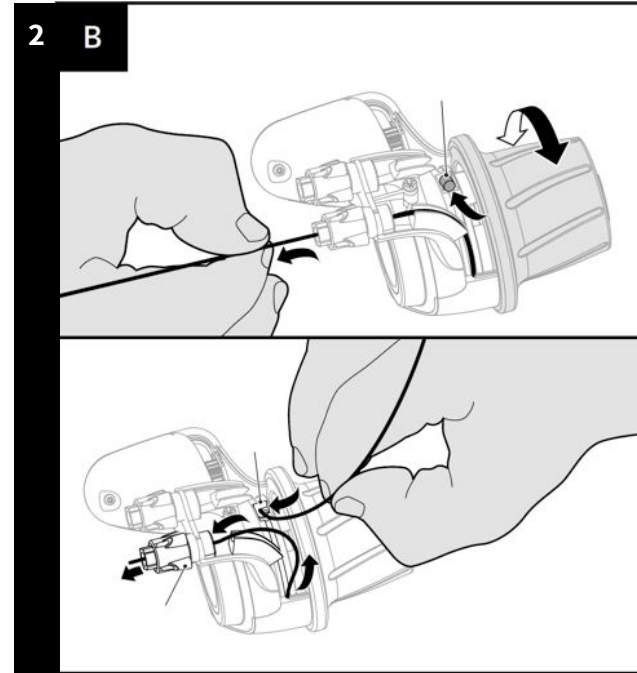
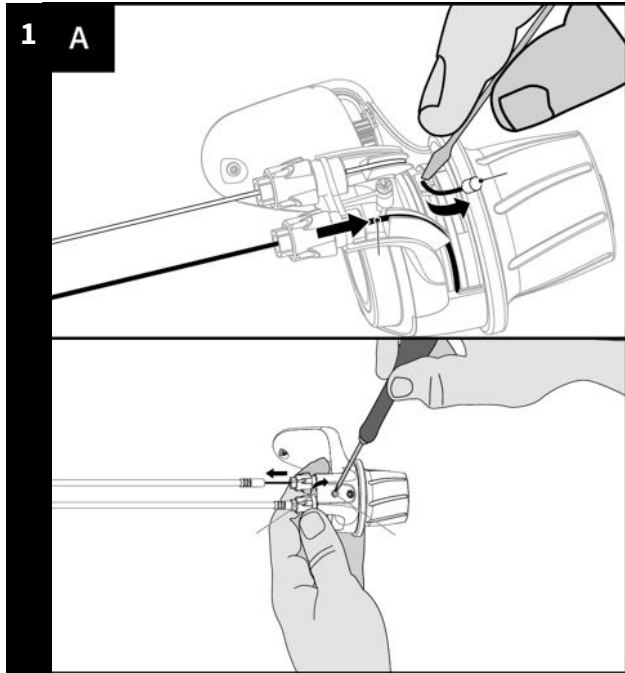

Setting proper cable length

enviolo

1

N

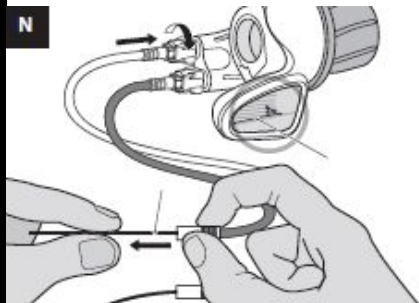

2

O

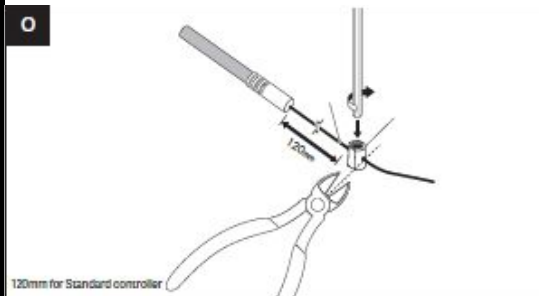

3

P



4

Q

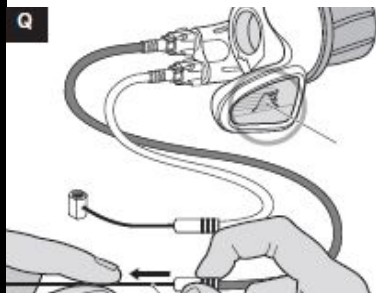

5

R

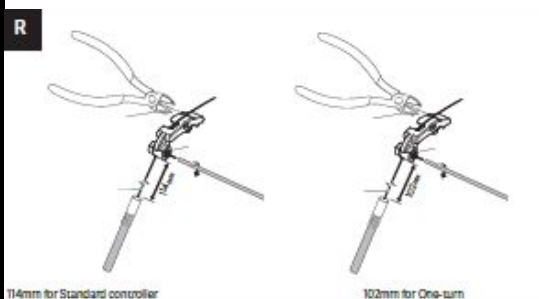

6

R

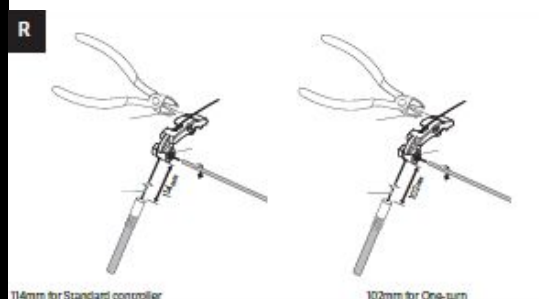

Setting the proper cable length

enviolo

N

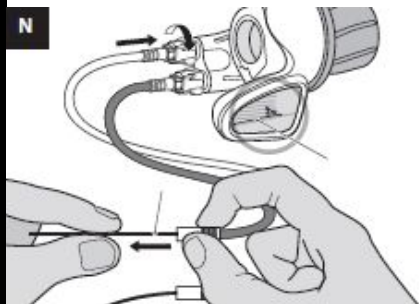

T

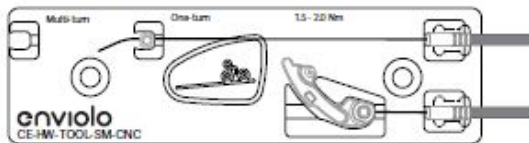

P

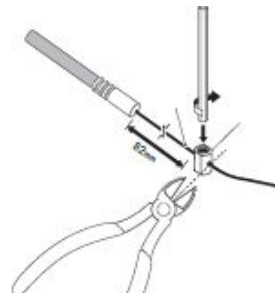

4

Q

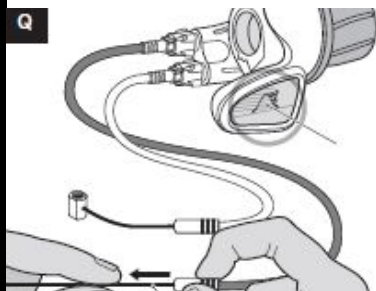

5

T

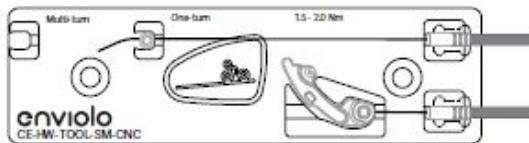

6

R

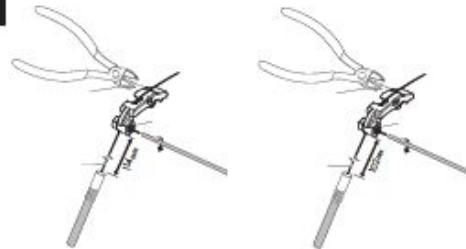

Cable slack and proper installation angle

enviolo

1 X



2 Y

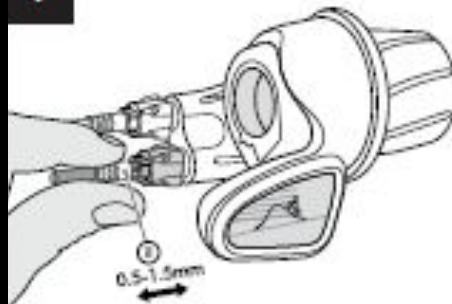

1 C

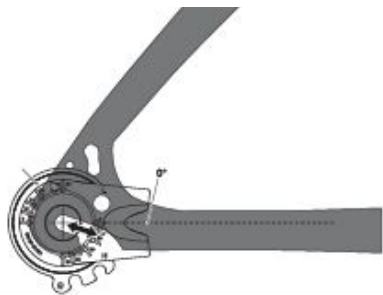

2 D

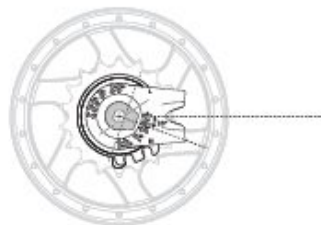



enviolo

Troubleshooting - Manual

CVP reset

enviolo

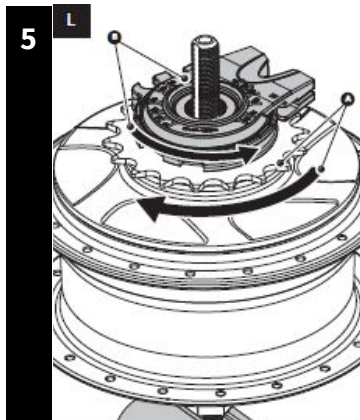
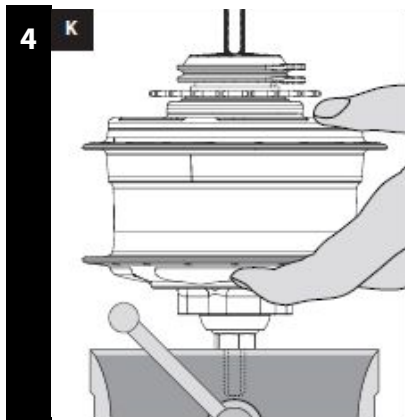
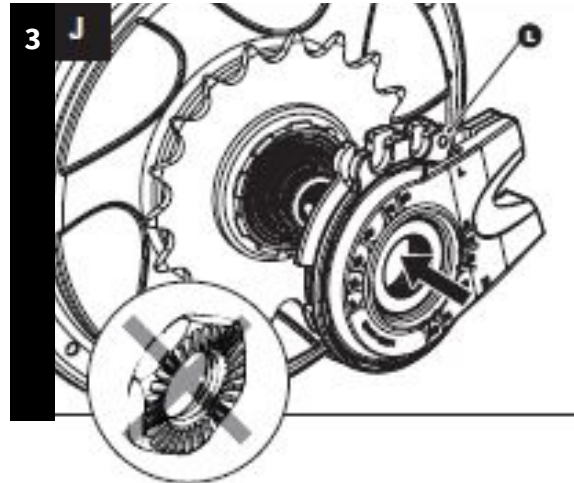
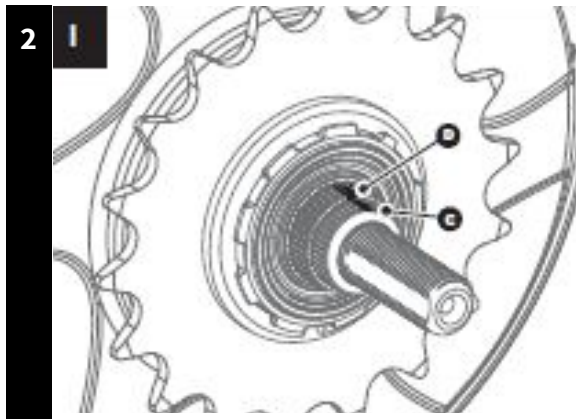
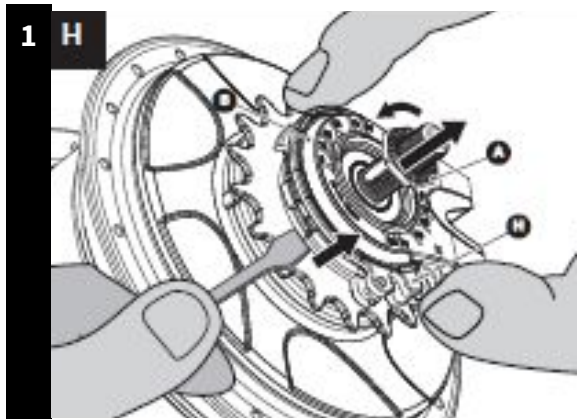

Wheel disassembly

enviolo

1

M

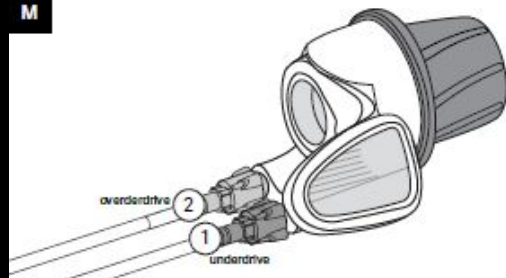

2

A

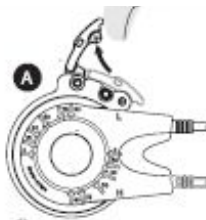

3

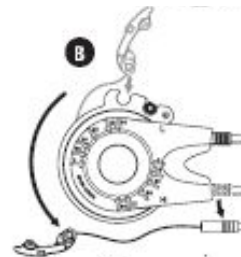

4

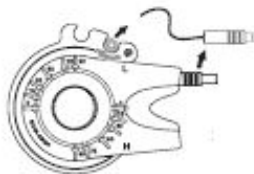
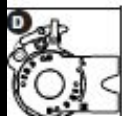

5

B

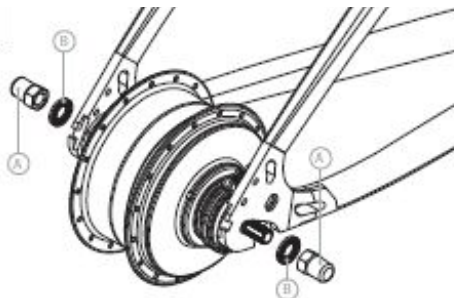

A close-up photograph of a bicycle's rear hub and cassette. The hub is a dark grey, multi-faceted shape with the 'enviolo AUTOMATiQ''' logo in white. It is mounted on a red frame. A black pedal is visible in the lower right, and a black chain is visible in the lower left. The background is a blurred grey wall.

enviolo
AUTOMATiQ'''

enviolo
AUTOMATiQ'''



envioio
AUTOMATIQA

AUTOMATiQ Hub Interface

enviolo
AUTOMATiQ™

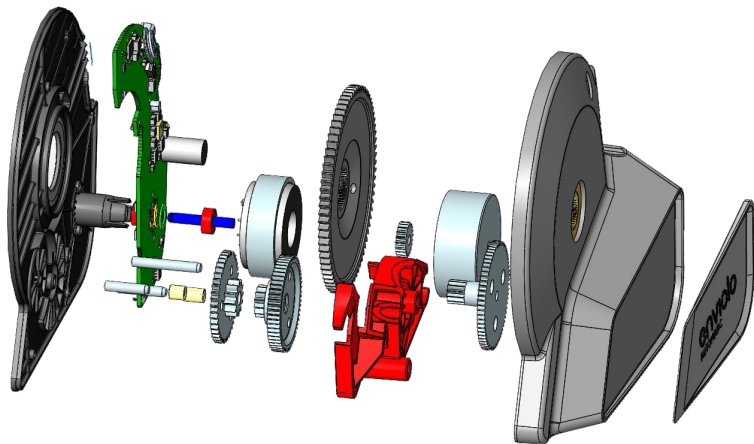

Automatic cadence control

Extended product lifetime & higher efficiency

Longevity with all applications

Strong shift motor

Integrated modern design

Traffic light function

Installation of the AUTOMATiQ Hub Interface

enviolo
AUTOMATiQ™

1

C

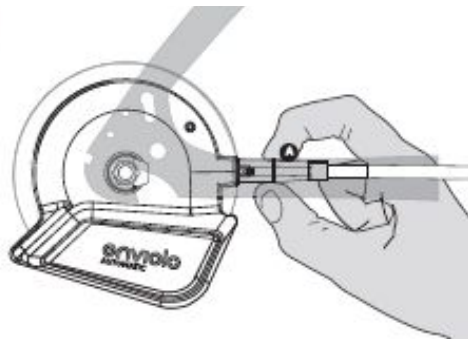

2

D

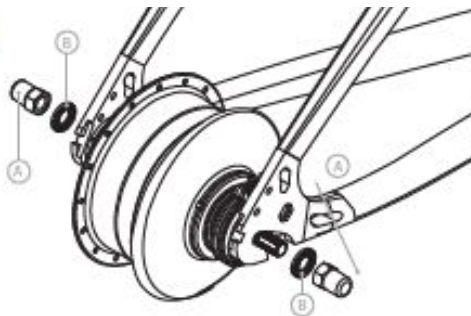

3

E

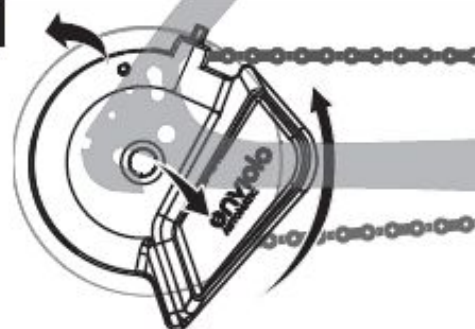

4

F



5

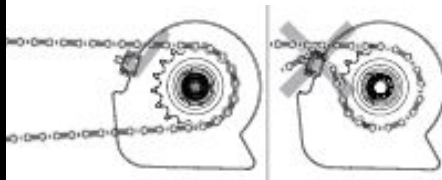

6

G

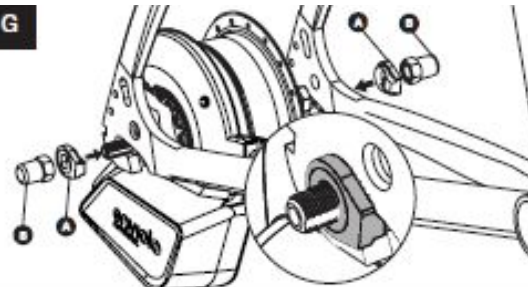

AUTOMATiQ App

enviolo
AUTOMATiQ)))



Configuration

Customize ride profiles to meet rider desires



Logistics

Offers firmware options and accelerates
warranty processing



Diagnostics

Over the air software updates generate easy
maintenance and faster service procedures



Dashboard

Intuitive user interface for ease of use



Benefits for retailers

enviolo
AUTOMATI*Q*™

Shifting under full load

Simplified assembly via optimized/reduced cable routing

Fast service processing through data transfer

High comfort and safety for inexperienced customers



Automatic Hub Interfaces



2019

Automatic
CCT



Automatic +
CCT



Automatic
CS



Automatic +
CS



2020

AUTOMATiQ
CCT



AUTOMATiQ + CCT -
Combined version



AUTOMATiQ
CS



AUTOMATiQ + CS -
Combined version



enviolo

Introducing the new
enviolo product portfolio

Groupsets specifically d
for unique use ca



Memberships

enviolo

Membership details - Training

enviolo

	Gold	Silver	Bronze
<u>Features & Benefits</u>			
Free tickets to the retail training series	3	2	1
Discount for additional tickets	✓	✓	
Warranty decision at retail location	✓	✓	
Labor reimbursement	✓		
Order on invoice	✓		
Discount for spare parts	20%	10%	5%

Membership details - Marketing

enviolo

	Gold	Silver	Bronze
Features & Benefits			
POS Kit Large			
POS Kit Medium			
Cut model			
Enviolo expert in website locator			
Price incl. Update voucher	399€	275€	199€
Price incl. Full Service Kit	699€	549€	399€

Membership Programm Point-of-Sale

POS Material

enviolo

Big

- Stand up display
- B2C brochures
- Handlebar hanger
- Cut model (only gold/silver)

Small

- A5 brochure holder
- B2C brochures
- Handlebar hanger

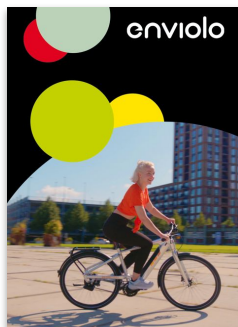

Membership overview

enviolo

300+ Members

enviolo.com/dealers



SERVICE POINT

Sele Radsport

Silligatter 40, 9492 Eschen

+423 373 49 53

WEBSITE



EXPERIENCE PARTNER

bikezeit

Pommernstraße 4, 93073 Neutraubling

+49 9401 9138 70

WEBSITE

TEST RIDE



EXPERIENCE PARTNER

e-motion e-Bike Welt Berlin-Mitte

Brunnenstraße 110d, 13355 Berlin

+49 30 239 29 567

WEBSITE

TEST RIDE



EXPERIENCE PARTNER

Peter Terlouw Tweewielers

Voordijk 275, 2992 AL Barendrecht

enviolo

Introducing the new
enviolo product portfolio.

Groupsets specifically designed
for unique use cases.



Online support

enviolo

CUSTOMER EXPERIENCE (CX) TEAM

- 3 languages available fluently: *German, Dutch and English*
- **Availability:** Monday to Friday from 09:00 - 16:30
- Contact details:
 - **Email :** support@enviolo.com
 - **Phone Germany:** +49 22892939079
 - **Phone US:** +1 888 688 4624
 - **Phone Rest of the world:** +31 85 049 8698



enviolo

Customer
Experience
(CX) team

9 FTE

< 2 min

Phone hold
time

< 4 hour

Email
response time
for all retailers

< 48 hours

In-house turn
around time
for warranty
parts

< 1 week

Turn around
time for
wheels

Individual login for all customers

Easy-to-use online warranty form

Overview of all communication

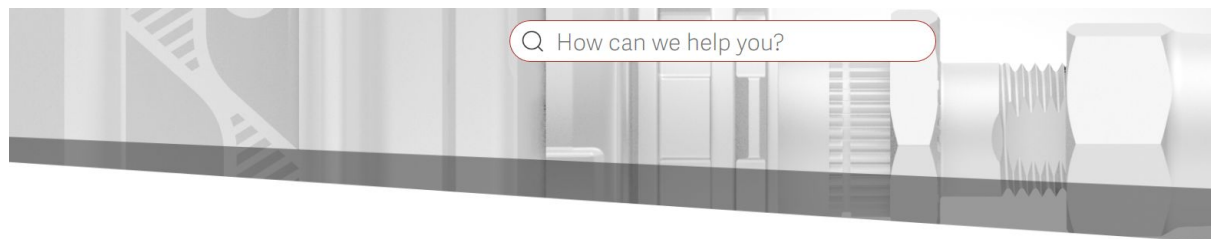
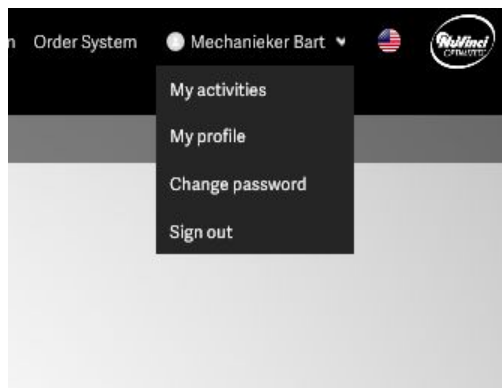

Most Read Articles

Troubleshooting

Manuals & Technical Documentation

Harmony™ and enviolo automatic Desktop Software

Manuals & Technical Documentation

enviolo Service Process

Service & Warranty

[See More](#)



General Information



Images and Logos



Manuals & Technical Documentation



Service & Warranty

Orders.enviolo.com

enviolo

Site Contains:

- Product Images
- Part Number
- Price
- Discounted Prices (memberships only)

More Payment Options

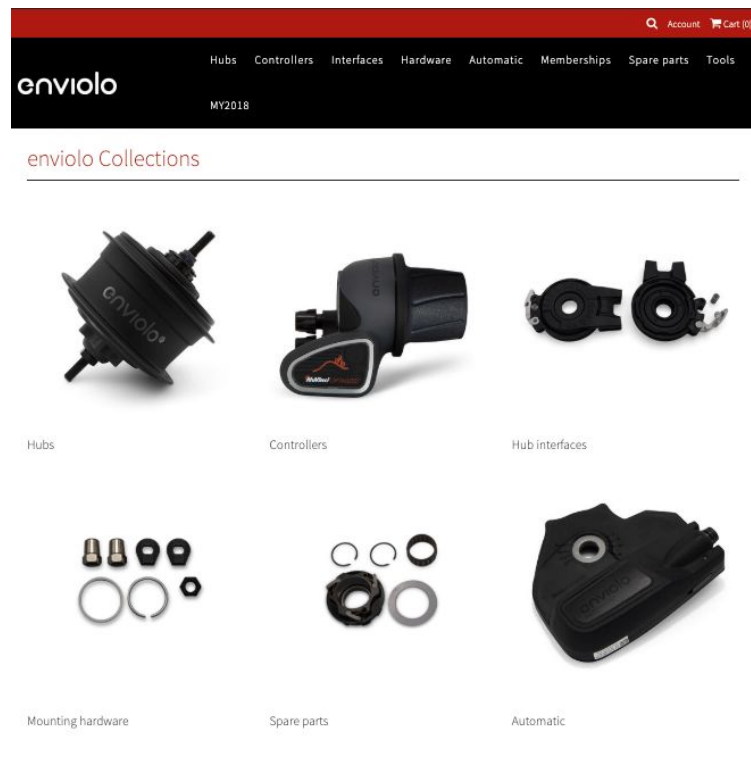



enviolo

Introducing the new
enviolo product portfolio.

Groupsets specifically designed
for unique use cases.



enviolo

Retail training series

Retail training series MY2020

enviolo



New Training Set-up:

- Full-day face-to-face training with 8 workshops
- Combining both practical and theory
- Become an enviolo expert on completion*

Modules:

- Features and benefits of enviolo's manual and automatic products
- Service & maintenance procedures
- Automatic system configuration
- Tips and tricks for technical service, sales & marketing

Q&A

Ende